

## Datasheet of 21SFKS46MXN Plug for panel mount

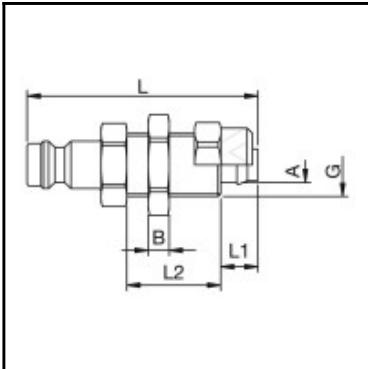

### Description

Plug straight-through, panel mount 4 x 6,3 mm, nominal diameter 5, <35 bar, brass nickel plated

Mini industrial coupling with the world's most popular profile in this nominal diameter. Above average flow performance for liquid and gaseous media. Coupling system with single-hand operation. Small dimensions and large band width in materials and valve variants.

### Details

|   |  |
|---|--|
| Series:                                   | 21   |
| Series long:                              | 21SF   |
| Bore in mm:                               | 5  |
| Bore area in mm²:                         | 20   |
| Advantages:                               | One-hand operation. Small dimensions. All variants are compatible.   |
| Compatibility:                            | RECTUS 90  |
| Working pressure:                         | 35 bar maximum static working pressure with safety factor 4 to 1.  |
| Working temperature:                      | -20°C up to +100°C (NBR) -40°C up to +120/150°C (EPDM) -15°C up to +200°C (FKM) 0°C up to +316°C (FFKM) depending on the medium. |
| Shut-Off:                                 | Plug Straight-Through  |
| Connection:                               | Panel mount 4 x 6,3 mm   |
| Connection description:                   | Panel mount 4 x 6,3 mm   |
| Connection type:                          | Connection nut   |
| Material:                                 | Brass nickel plated  |
| Material description:                     | Brass CuZn39Pb3 2.0401 (except sleeve)   |
| Surface:                                  | nickel plated  |
| Weight in kg:                             | 0,023  |
| Self-venting coupling:                    | No   |
| Safety locking system:                    | No   |
| Single-hand operation:                    | Yes  |
| Two-hand operation:                       | No   |
| Ball locking:                             | No   |
| Pin lock:                                 | No   |
| Ultra-FLO-valve:                          | No   |
| Vacuum suitable:                          | Yes  |
| Water-resistant:                          | Yes  |
| Flat-sealing:                             | No   |
| Suitable breath / respiratory protection: | No   |
| Pressure eliminator:                      | No   |
| Hydraulics:                               | No   |
| Pneumatics:                               | Yes  |
| Standard product:                         | No   |
| Mould coupling:                           | No   |

### Dimensions