

Datasheet of 21KFTF09MPX Quick coupling with hose barb

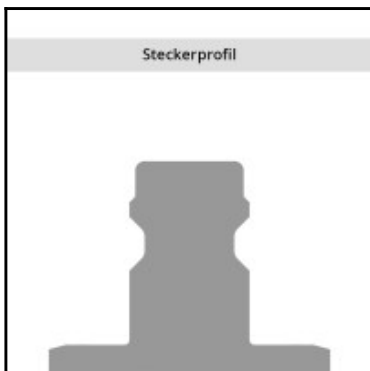
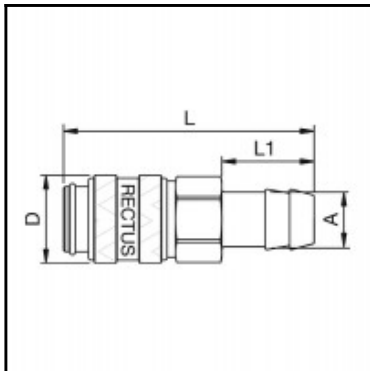

Description

Quick coupling straight-through, hose barb 9mm (3/8), nominal diameter 5, <35 bar, brass, seal NBR

Mini industrial coupling with the world's most popular profile in this nominal diameter. Above average flow performance for liquid and gaseous media. Coupling system with single-hand operation. Small dimensions and large band width in materials and valve variants.

Details

| | |
|---|--|
| Series: | 21 |
| Series long: | 21KF |
| Bore in mm: | 5 |
| Bore area in mm²: | 20 |
| Advantages: | One-hand operation. Small dimensions. All variants are compatible. |
| Compatibility: | RECTUS 90 |
| Working pressure: | 35 bar maximum static working pressure with safety factor 4 to 1. |
| Working temperature: | -20°C up to +100°C (NBR) -40°C up to +120/150°C (EPDM) -15°C up to +200°C (FKM) 0°C up to +316°C (FFKM) depending on the medium. |
| Shut-Off: | Quick coupling Straight-Through |
| Connection: | Hose barb 9mm LW(3/8") |
| Connection description: | Hose barb 9mm LW(3/8") |
| Connection type: | Hose barb |
| Material: | Brass |
| Material description: | Brass CuZn39Pb3 2.0401 (except sleeve) |
| Seal description: | Nitrite-butadiene rubber |
| Surface: | blank finish |
| Material connection: | Brass |
| Material valve body: | Brass |
| Material sleeve: | Brass |
| Material spring snap ring: | stainless steel AISI 301 |
| Material balls/pins: | Stainless steel AISI 420 |
| Material seal: | Perbunan® |
| Weight in kg: | 0,0272 |
| Self-venting coupling: | No |
| Safety locking system: | No |
| Single-hand operation: | Yes |
| Two-hand operation: | No |
| Ball locking: | Yes |
| Pin lock: | No |
| Ultra-FLO-valve: | No |
| Vacuum suitable: | Yes |
| Water-resistant: | Yes |
| Flat-sealing: | No |
| Suitable breath / respiratory protection: | No |
| Pressure eliminator: | No |
| Hydraulics: | No |
| Pneumatics: | Yes |
| Standard product: | No |
| Mould coupling: | No |

Dimensions

| | |
|---------------|------|
| Connection A: | 9 mm |
| D mm: | 16 |
| L mm: | 46 |
| L1 mm: | 17 |
| SW mm: | 14 |