

## Datasheet of 50SFTF06MXX Plug with hose barb

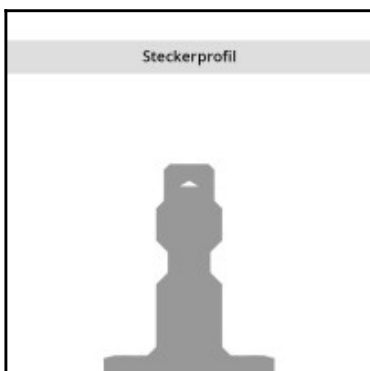
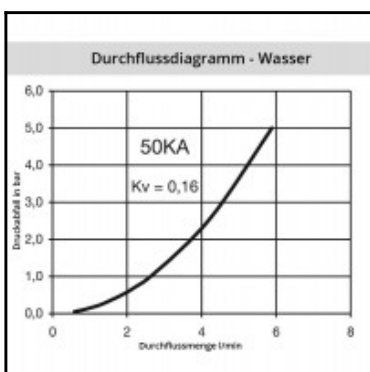
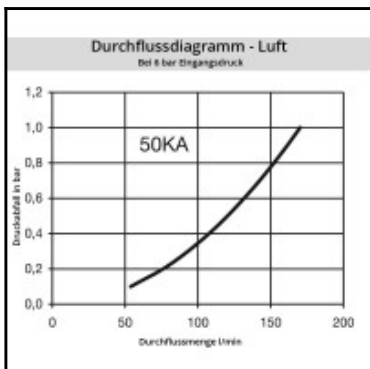
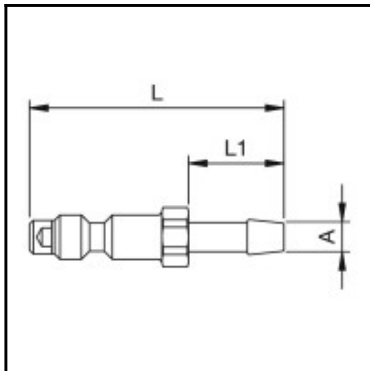

### Description

Plug straight-through, hose barb 6mm (1/4), nominal diameter 2,5, <35 bar, brass

Mini industrial coupling, can be used with various medio. Coupling system with single-hand operation. This system is extremely easy to operate and stands out for its small installation dimensions.

### Details

Series:	50
Series long:	50SF
Bore in mm:	2,5
Bore area in mm²:	5
Advantages:	One-hand operation. Small dimensions.
Working pressure:	35 bar maximum static working pressure with safety factor 4 to 1.
Working temperature:	-20°C up to +100°C (NBR) -40°C up to +120/150°C (EPDM) -15°C up to +200°C (FKM) depending on the medium.
Shut-Off:	Plug Straight-Through
Connection:	Hose barb 6mm LW(1/4")
Connection description:	Hose barb 6mm LW(1/4")
Connection type:	Hose barb
Material:	Brass
Material description:	Brass CuZn39Pb3 2.0401 (except sleeve)
Surface:	blank finish
Weight in kg:	0,005
Self-venting coupling:	No
Safety locking system:	No
Single-hand operation:	Yes
Two-hand operation:	No
Ball locking:	No
Pin lock:	No
Ultra-FLO-valve:	No
Vacuum suitable:	Yes
Water-resistant:	Yes
Flat-sealing:	No
Suitable breath / respiratory protection:	No
Pressure eliminator:	No
Hydraulics:	No
Pneumatics:	Yes
Standard product:	No
Mould coupling:	No

### Dimensions

Connection A:	6 mm
L mm:	35
L1 mm:	13
SW mm:	7