

Datasheet of 21SFTS05MXX Plug for panel mount with hose barb

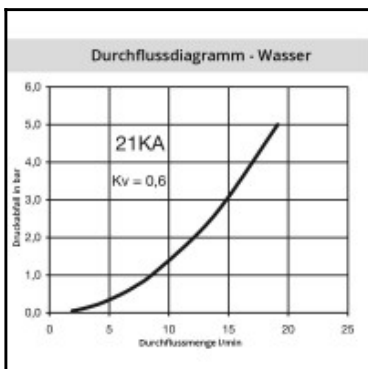
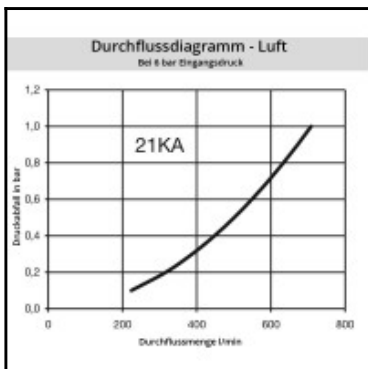
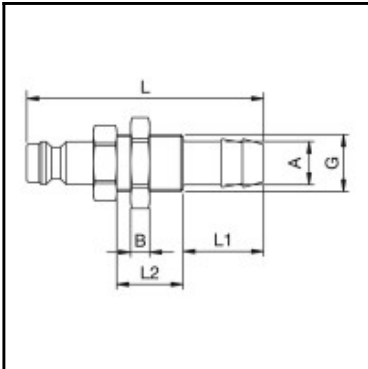

Description

Plug straight-through, panel mount with hose barb 5 mm, nominal diameter 5, <35 bar, brass

Mini industrial coupling with the world's most popular profile in this nominal diameter. Above average flow performance for liquid and gaseous media. Coupling system with single-hand operation. Small dimensions and large band width in materials and valve variants.

Details

| | |
|---|--|
| Series: | 21 |
| Series long: | 21SF |
| Bore in mm: | 5 |
| Bore area in mm²: | 20 |
| Advantages: | One-hand operation. Small dimensions. All variants are compatible. |
| Compatibility: | RECTUS 90 |
| Working pressure: | 35 bar maximum static working pressure with safety factor 4 to 1. |
| Working temperature: | -20°C up to +100°C (NBR) -40°C up to +120/150°C (EPDM) -15°C up to +200°C (FKM) 0°C up to +316°C (FFKM) depending on the medium. |
| Shut-Off: | Plug Straight-Through |
| Connection: | Hose barb in Panel mount 5 mm |
| Connection description: | Hose barb in Panel mount 5 mm |
| Connection type: | Hose barb |
| Material: | Brass |
| Material description: | Brass CuZn39Pb3 2.0401 (except sleeve) |
| Surface: | blank finish |
| Weight in kg: | 0,026 |
| Self-venting coupling: | No |
| Safety locking system: | No |
| Single-hand operation: | Yes |
| Two-hand operation: | No |
| Ball locking: | No |
| Pin lock: | No |
| Ultra-FLO-valve: | No |
| Vacuum suitable: | Yes |
| Water-resistant: | Yes |
| Flat-sealing: | No |
| Suitable breath / respiratory protection: | No |
| Pressure eliminator: | No |
| Hydraulics: | No |
| Pneumatics: | Yes |
| Standard product: | No |
| Mould coupling: | No |

Dimensions

| | |
|---------------|----------|
| Connection A: | 5 mm |
| B mm: | 4 |
| G mm: | M 12 x 1 |
| L mm: | 50 |
| L1 mm: | 17 |
| L2 mm: | 14 |
| SW mm: | 14 |
| SW1 mm: | 17 |