

## Datasheet of 17KATF10SPN Quick coupling with hose barb

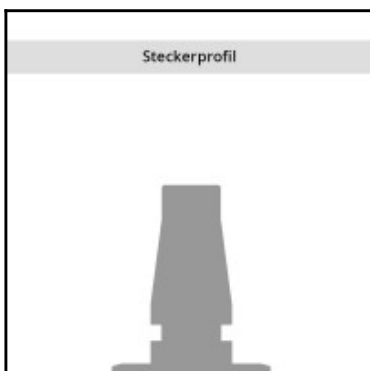
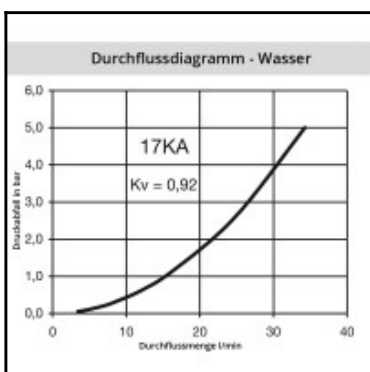
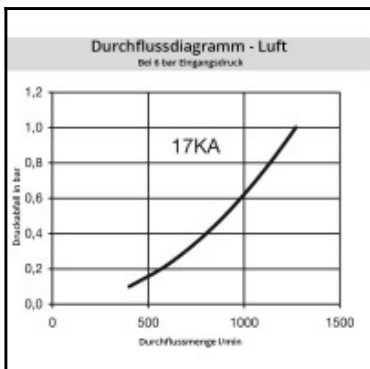
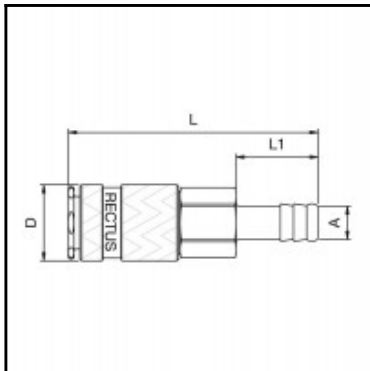

### Description

Quick coupling single shut-off, hose barb 10mm, nominal diameter 5, <35 bar, steel nickel plated, seal NBR

Brass/steel industrial coupling with English profile specifically suited to compressed air applications in industry. Coupling system with single-hand operation. UltraFlo valve for optimum flow and low pressure drop. Versatile due to slim design and light weight.

### Details

|   |  |
|---|--|
| Series:                                   | 17   |
| Series long:                              | 17KA   |
| Bore in mm:                               | 5  |
| Bore area in mm²:                         | 20   |
| Advantages:                               | One-hand operation. Schlanke Bauweise, light weight. UltraFlo valve.                                     |
| Working pressure:                         | 35 bar maximum static working pressure with safety factor 4 to 1.  |
| Working temperature:                      | -20°C up to +100°C (NBR) -40°C up to +120/150°C (EPDM) -15°C up to +200°C (FKM) depending on the medium. |
| Shut-Off:                                 | Quick coupling Single Shut-Off   |
| Connection:                               | Hose barb 10mm   |
| Connection description:                   | Hose barb 10mm   |
| Connection type:                          | Hose barb  |
| Material:                                 | Steel nickel-plated  |
| Material description:                     | Steel 9SMnPb28K 1.0718   |
| Seal description:                         | Nitrite-butadiene rubber   |
| Surface:                                  | nickel plated  |
| Material connection:                      | Brass nickel plated  |
| Material valve body:                      | steel, hardenedandzinc plated  |
| Material sleeve:                          | steel, hardenedandzinc plated  |
| Material valve:                           | Brass  |
| Material spring snap ring:                | stainless steel AISI 301   |
| Material balls/pins:                      | Stainless steel 420F   |
| Material seal:                            | Perbunan®  |
| Weight in kg:                             | 0,1116   |
| Self-venting coupling:                    | No   |
| Safety locking system:                    | No   |
| Single-hand operation:                    | Yes  |
| Two-hand operation:                       | No   |
| Ball locking:                             | Yes  |
| Pin lock:                                 | No   |
| Ultra-FLO-valve:                          | Yes  |
| Vacuum suitable:                          | Yes  |
| Water-resistant:                          | No   |
| Flat-sealing:                             | No   |
| Suitable breath / respiratory protection: | No   |
| Pressure eliminator:                      | No   |
| Hydraulics:                               | No   |
| Pneumatics:                               | Yes  |
| Standard product:                         | No   |
| Mould coupling:                           | No   |

### Dimensions

|               |       |
|---------------|-------|
| Connection A: | 10 mm |
| D mm:         | 23    |
| L mm:         | 76    |
| L1 mm:        | 25    |
| SW mm:        | 19    |