

Datasheet of 17KATF06SPN Quick coupling with hose barb

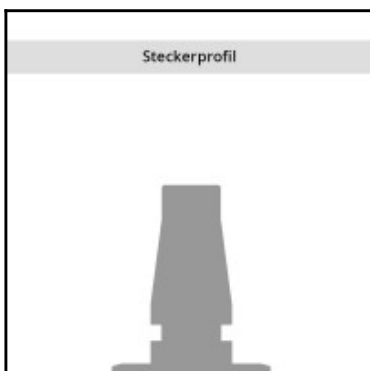
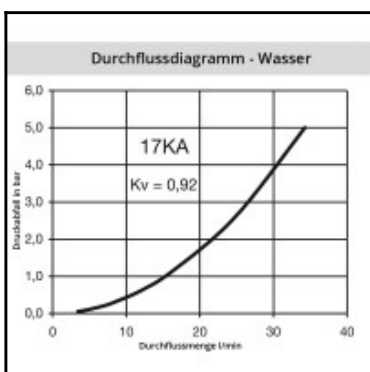
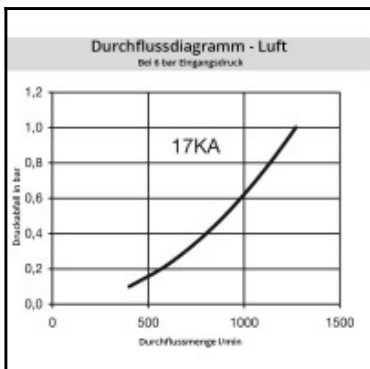
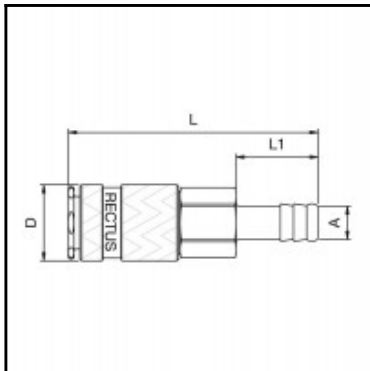

Description

Quick coupling single shut-off, hose barb 6mm (1/4), nominal diameter 5, <35 bar, steel nickel plated, seal NBR

Brass/steel industrial coupling with English profile specifically suited to compressed air applications in industry. Coupling system with single-hand operation. UltraFlo valve for optimum flow and low pressure drop. Versatile due to slim design and light weight.

Details

| | |
|---|--|
| Series: | 17 |
| Series long: | 17KA |
| Bore in mm: | 5 |
| Bore area in mm²: | 20 |
| Advantages: | One-hand operation. Schlanke Bauweise, light weight. UltraFlo valve. |
| Working pressure: | 35 bar maximum static working pressure with safety factor 4 to 1. |
| Working temperature: | -20°C up to +100°C (NBR) -40°C up to +120/150°C (EPDM) -15°C up to +200°C (FKM) depending on the medium. |
| Shut-Off: | Quick coupling Single Shut-Off |
| Connection: | Hose barb 6mm LW(1/4") |
| Connection description: | Hose barb 6mm LW(1/4") |
| Connection type: | Hose barb |
| Material: | Steel nickel-plated |
| Material description: | Steel 9SMnPb28K 1.0718 |
| Seal description: | Nitrite-butadiene rubber |
| Surface: | nickel plated |
| Material connection: | Brass nickel plated |
| Material valve body: | steel, hardenedandzinc plated |
| Material sleeve: | steel, hardenedandzinc plated |
| Material valve: | Brass |
| Material spring snap ring: | stainless steel AISI 301 |
| Material balls/pins: | Stainless steel 420F |
| Material seal: | Perbunan® |
| Weight in kg: | 0,1091 |
| Self-venting coupling: | No |
| Safety locking system: | No |
| Single-hand operation: | Yes |
| Two-hand operation: | No |
| Ball locking: | Yes |
| Pin lock: | No |
| Ultra-FLO-valve: | Yes |
| Vacuum suitable: | Yes |
| Water-resistant: | No |
| Flat-sealing: | No |
| Suitable breath / respiratory protection: | No |
| Pressure eliminator: | No |
| Hydraulics: | No |
| Pneumatics: | Yes |
| Standard product: | No |
| Mould coupling: | No |

Dimensions

| | |
|---------------|------|
| Connection A: | 6 mm |
| D mm: | 23 |
| L mm: | 76 |
| L1 mm: | 25 |
| SW mm: | 19 |