

Datasheet of 21KLTF06EVX Quick coupling with hose barb

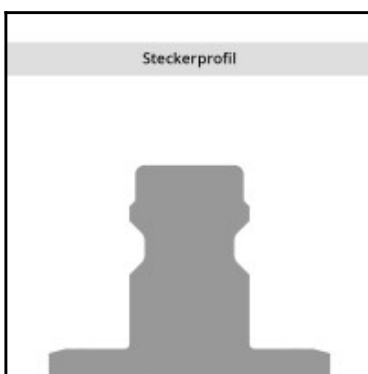
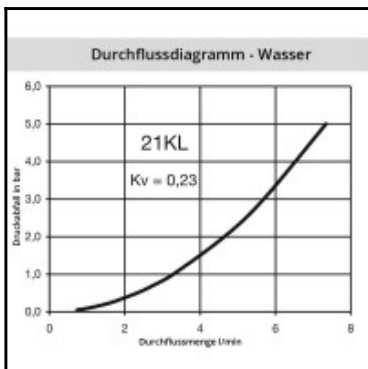
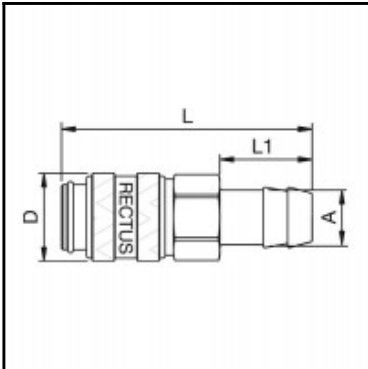

Description

Quick coupling dry-break double shut-off, hose barb 6mm (1/4), nominal diameter 5, <8 bar, stainless steel AISI 316 L, seal FKM

Mini industrial coupling with the world's most popular profile in this nominal diameter. Above average flow performance for liquid and gaseous medio. Coupling system with single-hand operation. Small dimensions and large band width in materials and valve variants.

Details

| | |
|---|---|
| Series: | 21 |
| Series long: | 21KL |
| Bore in mm: | 5 |
| Bore area in mm²: | 20 |
| Advantages: | One-hand operation. Small dimensions. Minimal, almost imperceptible leakage when uncoupling. No air locked into the system during the coupling process. |
| Working pressure: | PB = 8 bar maximum static working pressure with safety factor 4 to 1. |
| Working temperature: | -20°C up to +100°C (NBR) -40°C up to +120/150°C (EPDM) -15°C up to +200°C (FKM) depending on the medium. |
| Shut-Off: | Quick coupling Dry-Break (double shut-off) |
| Connection: | Hose barb 6mm LW(1/4") |
| Connection description: | Hose barb 6mm LW(1/4") |
| Connection type: | Hose barb |
| Material: | stainless steel AISI 316 L |
| Material description: | stainless steel 1.4404 |
| Seal description: | Fluororubber |
| Surface: | blank finish |
| Material connection: | stainless steel AISI 316 L |
| Material valve body: | stainless steel AISI 316 L |
| Material sleeve: | stainless steel AISI 316 L |
| Material valve: | stainless steel AISI 316 L |
| Material spring snap ring: | Stainless steel AISI 316Ti |
| Material balls/pins: | Stainless steel AISI 316 |
| Material seal: | Viton® |
| Weight in kg: | 0,028 |
| Self-venting coupling: | No |
| Safety locking system: | No |
| Single-hand operation: | Yes |
| Two-hand operation: | No |
| Ball locking: | Yes |
| Pin lock: | No |
| Ultra-FLO-valve: | No |
| Vacuum suitable: | Yes |
| Water-resistant: | No |
| Flat-sealing: | Yes |
| Suitable breath / respiratory protection: | No |
| Pressure eliminator: | No |
| Hydraulics: | No |
| Pneumatics: | Yes |
| Standard product: | No |
| Mould coupling: | No |

Dimensions

| | |
|---------------|------|
| Connection A: | 6 mm |
| D mm: | 16 |
| L mm: | 46 |
| L1 mm: | 17 |
| SW mm: | 14 |