

Datasheet of 21KBAW10DPX Quick coupling with male thread

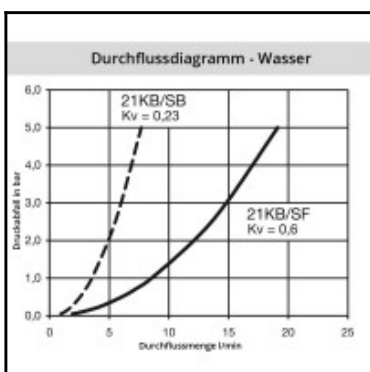
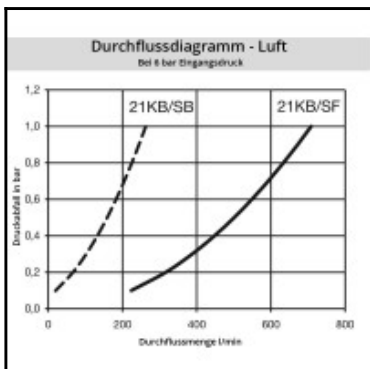
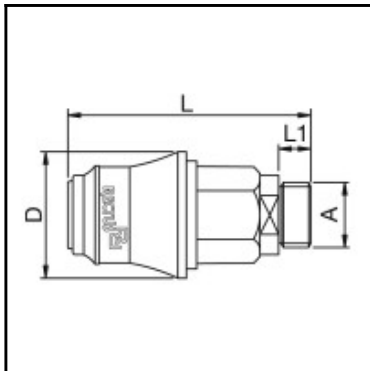

Description

Quick coupling double shut-off, male thread G 1/8, nominal diameter 5, <10 bar, POM (Delrin), seal NBR

Mini industrial coupling in plastics POM and PVDF with the world's most popular profile in this nominal diameter. Above average flow performance for liquid and gaseous media.

Details

| | |
|---|--|
| Series: | 21 |
| Series long: | 21KB |
| Bore in mm: | 5 |
| Bore area in mm²: | 20 |
| Advantages: | Coupling system with single-hand operation. This new type of plastic locking system with handy sleeve considerably expands the applications of this series. Two sleeve forms - tapered and cylindrical, where the tapered sleeve form facilitates handling with gloves. The color coding of the coupling and plug offers a guarantee for avoiding mix-ups between media when coupling. |
| Working pressure: | 10 bar (POM, at 20°C), 8 bar (PVDF, at 20°C) maximum static working pressure with safety factor 4 to 1. |
| Working temperature: | -20°C up to +80°C (POM) -20°C up to +120°C (PVDF) depending on the medium. |
| Shut-Off: | Quick coupling Double Shut-Off |
| Connection: | Male thread 1/8" |
| Connection description: | Male pipe thread of Whitworth form ISO 228 1/8" |
| Connection type: | Male thread |
| Material: | POM (Delrin) |
| Material description: | POM (Delrin) |
| Seal description: | Nitrite-butadiene rubber |
| Surface: | blank finish |
| Material connection: | POM, black |
| Material valve body: | POM, black |
| Material sleeve: | POM, black |
| Material valve: | POM, black |
| Material spring snap ring: | stainless steel AISI 301 |
| Material balls/pins: | POM, black |
| Material seal: | Perbunan® |
| Weight in kg: | 0,013 |
| Self-venting coupling: | No |
| Safety locking system: | No |
| Single-hand operation: | Yes |
| Two-hand operation: | No |
| Ball locking: | No |
| Pin lock: | No |
| Ultra-FLO-valve: | No |
| Vacuum suitable: | Yes |
| Water-resistant: | Yes |
| Flat-sealing: | No |
| Suitable breath / respiratory protection: | No |
| Pressure eliminator: | No |
| Hydraulics: | No |
| Pneumatics: | Yes |
| Standard product: | No |
| Mould coupling: | No |

Dimensions

| | |
|---------------|-------|
| Connection A: | G 1/8 |
| D mm: | 25,5 |
| L mm: | 50 |
| L1 mm: | 7 |
| SW mm: | 17 |