

## Datasheet of 21KAKO06MPN8 Quick coupling with male thread

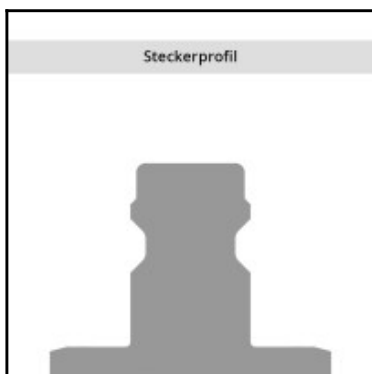
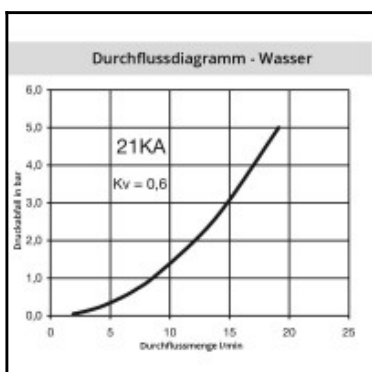
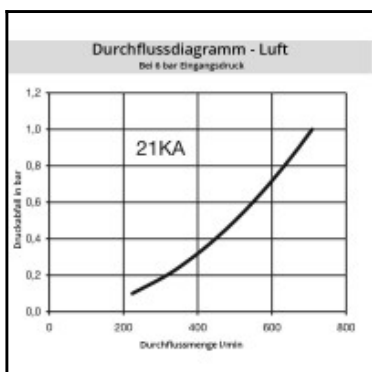
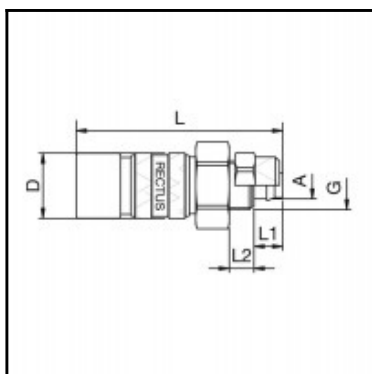

### Description

Quick coupling single shut-off, coded system (8 = red, octagonal), with hose nut 4 x 6 mm, nominal diameter 5, <35 bar, brass nickel plated, seal NBR

Coded industrial coupling system developed on the basis of series 21 with above-average flow rate for liquid and gaseous media. Coupling system with single-hand operation. The mechanical coding of the coupling and plug offers a guarantee for avoiding mix-ups between media when coupling, which is complemented by the color coding of the anodised sleeves. Double shut-off version available on request.

### Details

|                                           |                                                                   |
|-------------------------------------------|-------------------------------------------------------------------|
| Series:                                   | 21                                                                |
| Series long:                              | 21KA                                                              |
| Bore in mm:                               | 5                                                                 |
| Bore area in mm²:                         | 20                                                                |
| Advantages:                               | Quality product. One-hand operation.                              |
| Working pressure:                         | 35 bar maximum static working pressure with safety factor 4 to 1. |
| Working temperature:                      | -20°C up to +100°C (NBR)                                          |
| Shut-Off:                                 | Quick coupling Single Shut-Off                                    |
| Connection:                               | with tube nut 4 x 6 mm                                            |
| Connection description:                   | with tube nut 4 x 6 mm                                            |
| Connection type:                          | Connection nut                                                    |
| Material:                                 | Brass nickel plated                                               |
| Material description:                     | Brass CuZn39Pb3 2.0401 (except sleeve)                            |
| Seal description:                         | Nitrile-butadiene rubber                                          |
| Surface:                                  | nickel plated                                                     |
| Coding:                                   | 8 = red, octagonal                                                |
| Material connection:                      | Brass nickel plated                                               |
| Material valve body:                      | Brass nickel plated                                               |
| Material sleeve:                          | Brass nickel plated                                               |
| Material valve:                           | Brass                                                             |
| Material spring snap ring:                | stainless steel AISI 301                                          |
| Material balls/pins:                      | Stainless steel AISI 420                                          |
| Material seal:                            | Perbunan®                                                         |
| Weight in kg:                             | 0,038                                                             |
| Coded:                                    | Yes                                                               |
| Self-venting coupling:                    | No                                                                |
| Safety locking system:                    | No                                                                |
| Single-hand operation:                    | Yes                                                               |
| Two-hand operation:                       | No                                                                |
| Ball locking:                             | Yes                                                               |
| Pin lock:                                 | No                                                                |
| Ultra-FLO-valve:                          | No                                                                |
| Vacuum suitable:                          | Yes                                                               |
| Water-resistant:                          | Yes                                                               |
| Flat-sealing:                             | No                                                                |
| Suitable breath / respiratory protection: | No                                                                |
| Pressure eliminator:                      | No                                                                |
| Hydraulics:                               | No                                                                |
| Pneumatics:                               | Yes                                                               |
| Standard product:                         | No                                                                |
| Mould coupling:                           | No                                                                |

### Dimensions

|               |          |
|---------------|----------|
| Connection A: | 4 x 6 mm |
| D mm:         | 16       |
| G mm:         | M10x1    |
| L mm:         | 51       |
| L1 mm:        | 7        |
| L2 mm:        | 6        |
| SW mm:        | 14       |