

Datasheet of 21KAAW10MPX3 Quick coupling with male thread

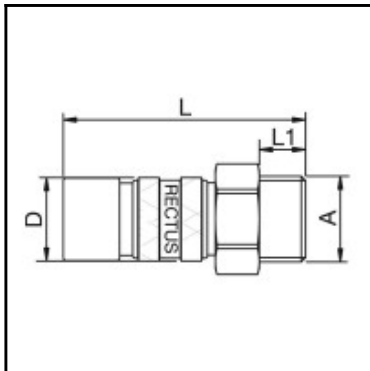

Description

Quick coupling single shut-off, coded system (3 = brown, triangle), male thread G 1/8, nominal diameter 5, <35 bar, brass, seal NBR

Coded industrial coupling system developed on the basis of series 21 with above-average flow rate for liquid and gaseous media. Coupling system with single-hand operation. The mechanical coding of the coupling and plug offers a guarantee for avoiding mix-ups between media when coupling, which is complemented by the color coding of the anodised sleeves. Double shut-off version available on request.

Details

| | |
|---|---|
| Series: | 21 |
| Series long: | 21KA |
| Bore in mm: | 5 |
| Bore area in mm²: | 20 |
| Advantages: | Quality product. One-hand operation. |
| Working pressure: | 35 bar maximum static working pressure with safety factor 4 to 1. |
| Working temperature: | -20°C up to +100°C (NBR) |
| Shut-Off: | Quick coupling Single Shut-Off |
| Connection: | Male thread 1/8" |
| Connection description: | Male pipe thread of Whitworth form ISO 228 1/8" |
| Connection type: | Male thread |
| Material: | Brass |
| Material description: | Brass CuZn39Pb3 2.0401 (except sleeve) |
| Seal description: | Nitrite-butadiene rubber |
| Surface: | blank finish |
| Coding: | 3 = brown, triangle |
| Material connection: | Brass |
| Material valve body: | Brass |
| Material sleeve: | Brass |
| Material valve: | Brass |
| Material spring snap ring: | stainless steel AISI 301 |
| Material balls/pins: | Stainless steel AISI 420 |
| Material seal: | Perbunan® |
| Weight in kg: | 0,032 |
| Coded: | Yes |
| Self-venting coupling: | No |
| Safety locking system: | No |
| Single-hand operation: | Yes |
| Two-hand operation: | No |
| Ball locking: | Yes |
| Pin lock: | No |
| Ultra-FLO-valve: | No |
| Vacuum suitable: | Yes |
| Water-resistant: | Yes |
| Flat-sealing: | No |
| Suitable breath / respiratory protection: | No |
| Pressure eliminator: | No |
| Hydraulics: | No |
| Pneumatics: | Yes |
| Standard product: | No |
| Mould coupling: | No |

Dimensions

| | |
|---------------|-------|
| Connection A: | G 1/8 |
| D mm: | 16 |
| L mm: | 47 |
| L1 mm: | 7 |
| SW mm: | 14 |