

## Datasheet of 26SFTS13MXN6 Plug color coded

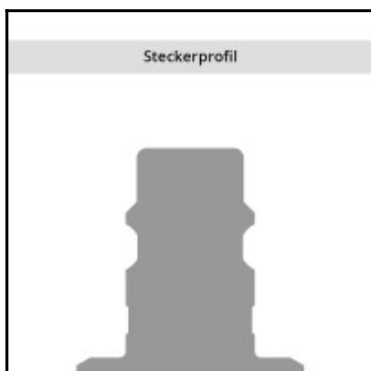
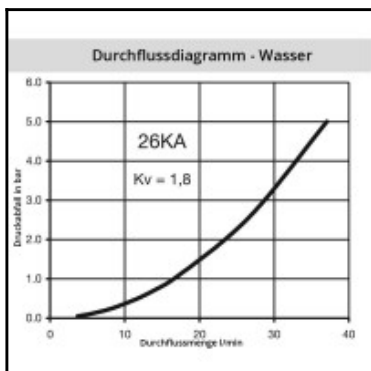
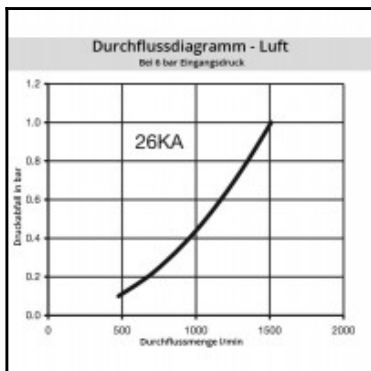
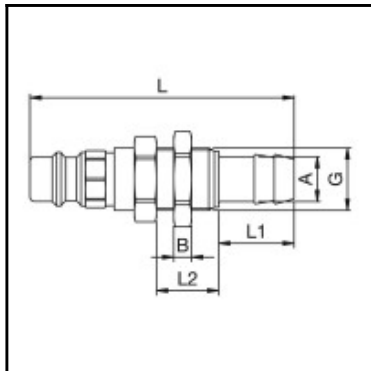

### Description

Plug straight-through, coded system (6 = blue, hexagon), panel mount with hose barb 13mm (1/2), nominal diameter 7,2, <35 bar, brass nickel plated

Coded industrial coupling system developed on the basis of series 25. Coupling system with single-hand operation. UltraFlo valve for optimum flow and low pressure drop. The mechanical coding of the coupling and plug offers a guarantee for avoiding mix-ups between media when coupling, which is complemented by the color coding of the anodised sleeves. Double shut-off and straightthrough couplings are available upon request. Cannot be interconnected with the Rectus standard 25 series.

### Details

|   |   |
|---|---|
| Series:                                   | 26  |
| Series long:                              | 26SF  |
| Bore in mm:                               | 7,2   |
| Bore area in mm²:                         | 40  |
| Advantages:                               | Quality product. One-hand operation. Versatile capability of connections. |
| Working pressure:                         | 35 bar maximum static working pressure with safety factor 4 to 1.         |
| Working temperature:                      | -20°C up to +100°C (NBR)  |
| Shut-Off:                                 | Plug Straight-Through   |
| Connection:                               | Hose barb in Panel mount 13mm LW(1/2")                                    |
| Connection description:                   | Hose barb in Panel mount 13mm LW(1/2")                                    |
| Connection type:                          | Hose barb   |
| Material:                                 | Brass nickel plated   |
| Material description:                     | Brass CuZn39Pb3 2.0401 (except sleeve)                                    |
| Surface:                                  | nickel plated   |
| Coding:                                   | 6 = blue, hexagon   |
| Weight in kg:                             | 0,002   |
| Coded:                                    | Yes   |
| Self-venting coupling:                    | No  |
| Safety locking system:                    | No  |
| Single-hand operation:                    | Yes   |
| Two-hand operation:                       | No  |
| Ball locking:                             | No  |
| Pin lock:                                 | No  |
| Ultra-FLO-valve:                          | No  |
| Vacuum suitable:                          | Yes   |
| Water-resistant:                          | Yes   |
| Flat-sealing:                             | No  |
| Suitable breath / respiratory protection: | No  |
| Pressure eliminator:                      | No  |
| Hydraulics:                               | No  |
| Pneumatics:                               | Yes   |
| Standard product:                         | No  |
| Mould coupling:                           | No  |

### Dimensions

|               |          |
|---------------|----------|
| Connection A: | 13 mm    |
| B mm:         | 4        |
| G mm:         | M 16 x 1 |
| L mm:         | 60       |
| L1 mm:        | 25       |
| L2 mm:        | 14       |
| SW mm:        | 17       |
| SW1 mm:       | 19       |