

Datasheet of 2297 12 19 Quick coupling with hose barb

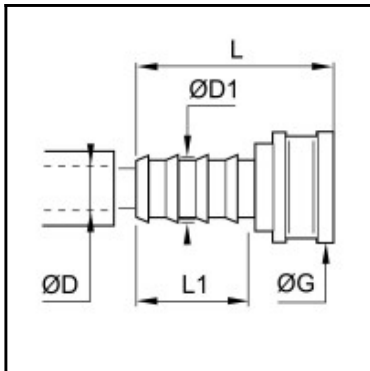

Description

Quick coupling straight-through, hose barb 19mm, nominal diameter 12, <20 bar, brass nickel plated, seal NBR

The Medium series is particularly suitable for water and compressed air applications. The wide range of connectors allows many combination options for the end user.

- Designed to transport water and liquids
- High flow capability
- Maximum energy efficiency

Details

Series:	Medium
ØD:	19
ØD1:	20,5
G:	29
L:	57
L1:	33
Flow rate in l/min:	2.200 (air)
Material connection:	Brass nickel plated
Series long:	Medium
Working temperature:	-20°C up to +100°C (NBR)
Surface:	nickel plated
Shut-Off:	Quick coupling Straight-Through
Connection:	Hose barb 19 mm
Connection description:	Plug
Connection type:	Hose barb
Connection tube outside diameter 2:	19
Connection tube outside diameter 3:	20,5
Bore in mm:	12
Maximum working pressure in bar:	20
Material seal:	NBR
Material:	Brass nickel plated
RoHS compliant:	Yes
Weight in kg:	0,0955

Dimensions

ØD:	19
ØD1:	20,5
G:	29
L:	57
L1:	33