

Datasheet of 0195 10 00 Plug with hose barb

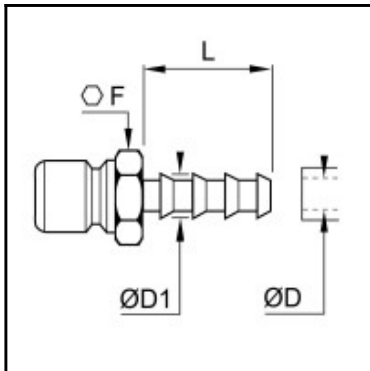

Description

Plug straight-through, hose barb 10mm, nominal diameter 12, <20 bar, brass nickel plated

The Medium series is particularly suitable for water and compressed air applications. The wide range of connectors allows many combination options for the end user.

- Designed to transport water and liquids
- High flow capability
- Maximum energy efficiency

Details

Series:	Medium
ØD:	10
ØD1:	12,2
F:	17
L:	29,5
Flow rate in l/min:	2.200 (air)
Material connection:	Brass nickel plated
Series long:	Medium
Working temperature:	-20°C up to +100°C (NBR)
Surface:	nickel plated
Shut-Off:	Plug Straight-Through
Connection:	Hose barb 10mm
Connection type:	Hose barb
Connection tube outside diameter 2:	10
Connection tube outside diameter 3:	12,2
Bore in mm:	12
Maximum working pressure in bar:	20
Material:	Brass nickel plated
RoHS compliant:	Yes
Weight in kg:	0,0304

Dimensions

ØD:	10
ØD1:	12,2
F:	17
L:	29,5