

Datasheet of 0181 04 06 Plug with hose barb

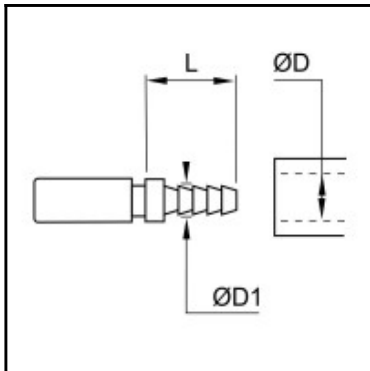

Description

Plug straight-through, hose barb 4mm, nominal diameter 3, <20 bar, brass nickel plated

The one-way shut-off mini series offers a space-saving solution for frequent connection and disconnection of hoses and pneumatic connections.

- Compact construction and ergonomic design
- Color coding: recognizing the circuits at a glance
- Easy uncoupling / one-handed operation

Details

| | |
|-------------------------------------|----------------------------------|
| Series: | Mini |
| ØD: | 4 |
| ØD1: | 4,7 |
| L: | 19 |
| Flow rate in l/min: | 165 (air) |
| Material connection: | Brass nickel plated |
| Series long: | Mini |
| Working temperature: | -20°C to +60°C (NBR) |
| Surface: | nickel plated |
| Shut-Off: | Plug Straight-Through |
| Connection: | Hose barb 4 mm |
| Connection description: | Hose barb for polyamid hose (PA) |
| Connection type: | Hose barb |
| Connection tube outside diameter 2: | 4 |
| Connection tube outside diameter 3: | 4,7 |
| Bore in mm: | 3 |
| Maximum working pressure in bar: | 20 |
| Material: | Brass nickel plated |
| RoHS compliant: | Yes |
| Weight in kg: | 0,005 |

Dimensions

| | |
|------|-----|
| ØD: | 4 |
| ØD1: | 4,7 |
| L: | 19 |