

Datasheet of 0187 05 13 Plug with male thread

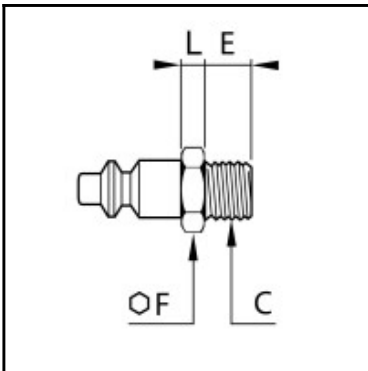

Description

Plug straight-through, male thread G 1/4, nominal diameter 5, <20 bar, galvanized steel

The standard range offers a robust construction and a good compromise between size and flow performance.

- Robust construction - perfect solution for demanding applications
- Nickel-plated brass for corrosion resistance

Details

Series:	Standard
C:	G 1/4"
E:	9,5
F:	17
L:	5
Flow rate in l/min:	480 (air)
Material connection:	Galvanized steel
Series long:	Standard
Working temperature:	-20°C to +80°C (NBR)
Surface:	zinc plated
Shut-Off:	Plug Straight-Through
Connection:	Male thread G 1/4
Material sleeve:	Galvanized steel
Connection description:	BSPP
Connection type:	Male thread
Bore in mm:	5
Maximum working pressure in bar:	20
Material:	Galvanized steel
RoHS compliant:	Yes
Weight in kg:	0,0278

Dimensions

Size connection 1:	G1/4
C:	G 1/4"
E:	9,5
F:	17
L:	5