

## Datasheet of GMA3/08LOMDCF In-Line Diagnostic Fittings and Adapters



### Description

Union tee GMA3, male thread M 14 x 1,5, steel, sealing edge

Parker's diagnostic items are designed to connect to hose or tubing without removing the fitting adapter and can be used in conjunction with electronic diagnostic items and mechanical pressure + temperature sensors. This line of products has been designed for use with the electronic diagnostic products and other mechanical pressure and temperature measurement devices, and can be installed on hose or tubing without removing the port adapter.

### Features/Benefits:

- ORFS and the 37° flare rotation feature allow unrestricted positioning without having to remove the port adapter.
- Enlarged and lengthened diagnostic port housing hex head screw allows for full thread insertion and a large pressure range.
- The line of diagnostic tees includes: diagnostic test point (EMA3 and PD series), conversion adapters and pressure gauge adapters.
- Steel construction in sizes 1/4" to 1 1/2" or 6 mm to 38 mm with working pressures up to 10,000 psi.

### Applications:

- Inline pressure and temperature measurement
- Inline oil sampling
- On-site diagnostics without removing the connector adapters

### Details

ØD1:	8
ØD3:	6
L1:	35
L2:	21
L3:	10
Series:	3
Weight in kg:	0,124
L5:	49,0
Connection tube outside diameter 1:	8 mm
Connection tube outside diameter 2:	8 mm
Series long:	3
Seals:	Sealing edge
Material:	Steel
Maximum working pressure in bar:	315

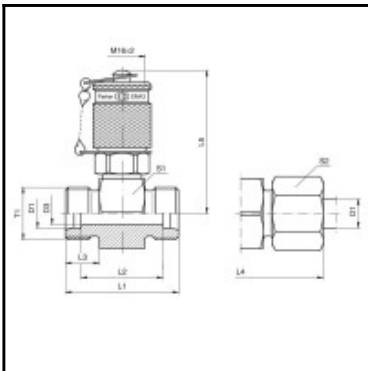

### Dimensions

Size connection 1:	Female thread M 14 x 1,5
ØD1:	8
ØD3:	6
T1:	M 14x1,5
L1:	35
L2:	21
L3:	10
L4:	51
S1:	24
S2:	17
Size connection 2:	M 16x2
Connection 1:	Male thread
Connection 2:	M16 test point connector