

Datasheet of QR-720 Quick-action chuck

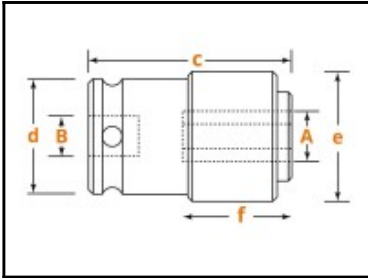

Description

Internal square drive for 5/8" bits with power drive, square drive 3/4"

Quick-action chuck for quick replacement of power-driven bits. The bit is held securely in the chuck. The bit is released again by moving the knurled sleeve.

Details

B:	3/4"
Drive:	3/4" Internal square drive
Weight in kg:	0,3
Material:	Tool steel

Dimensions

A:	5/8"
B:	3/4"
c in mm:	79
d in mm:	38
e in mm:	41
f in mm:	38