

Datasheet of QR-714 Quick-action chuck

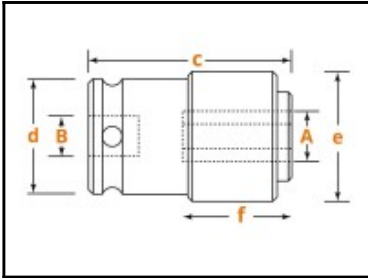

Description

Internal square drive for 7/16" bits with power drive, square drive 3/4"

Quick-action chuck for quick replacement of power-driven bits. The bit is held securely in the chuck. The bit is released again by moving the knurled sleeve.

Details

B:	3/4"
Drive:	3/4" Internal square drive
Weight in kg:	0,3
Material:	Tool steel

Dimensions

A:	7/16"
B:	3/4"
c in mm:	60
d in mm:	38
e in mm:	32
f in mm:	27