

## Datasheet of QR-514 Quick-action chuck

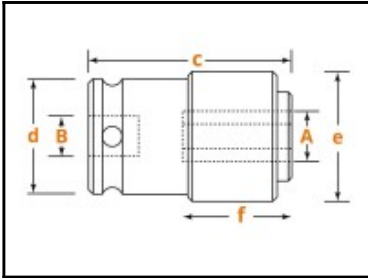

### Description

Internal square drive for 7/16" bits with power drive, square drive 1/2"

Quick-action chuck for quick replacement of power-driven bits. The bit is held securely in the chuck. The bit is released again by moving the knurled sleeve.

### Details

B:	1/2"
Drive:	1/2" Internal square drive
Weight in kg:	0,21
Material:	Tool steel

### Dimensions

A:	7/16"
B:	1/2"
c in mm:	54
d in mm:	25
e in mm:	32
f in mm:	27