

Datasheet of QR-308 Quick-action chuck

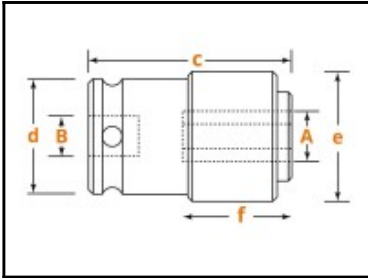

Description

Internal square drive for 1/4" bits with power drive, square drive 3/8"

Quick-action chuck for quick replacement of power-driven bits. The bit is held securely in the chuck. The bit is released again by moving the knurled sleeve.

Details

B:	3/8"
Drive:	3/8" Internal square drive
Weight in kg:	0,064
Material:	Tool steel

Dimensions

A:	1/4"
B:	3/8"
c in mm:	45
d in mm:	19
e in mm:	19
f in mm:	24