

Datasheet of 25KDAW17BPN Quick coupling with male thread

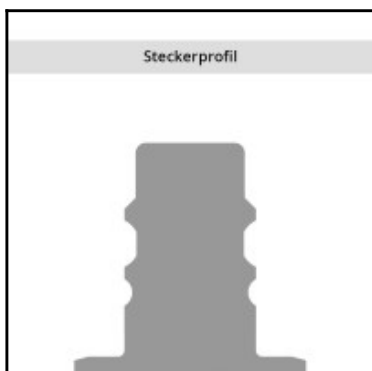
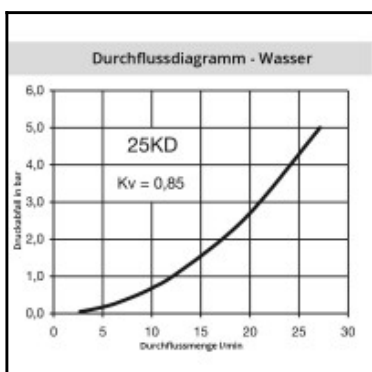
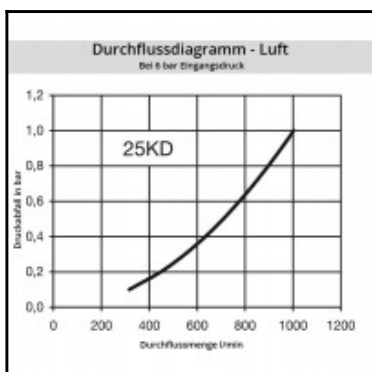
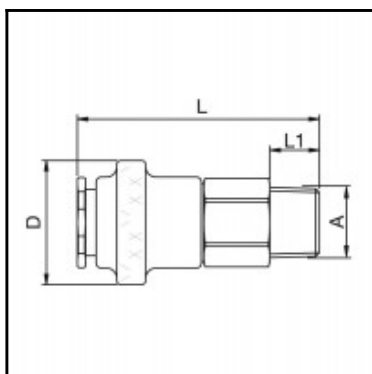

Description

Quick coupling safety double shut-off, male thread G 3/8, nominal diameter 7,4, <35 bar, brass nickel plated, seal NBR

35 bar (Brass-Version) 70 bar (with steel body and steel sleeve) maximum static working pressure with safety factor 4 to 1.

Details

| | |
|---|--|
| Series: | 25 |
| Series long: | 25KD |
| Bore in mm: | 7,4 |
| Bore area in mm²: | 43 |
| Advantages: | Handy sleeve for optimum operation even with gloves. |
| Working pressure: | 35 bar maximum static working pressure with safety factor 4 to 1. |
| Working temperature: | -20°C up to +100°C (NBR) -40°C up to +120/150°C (EPDM) -15°C up to +200°C (FKM) 0°C up to +316°C (FFKM) depending on the medium. |
| Shut-Off: | Quick coupling Safety (double shut-off) |
| Connection: | Male thread 3/8" |
| Connection description: | Male pipe thread of Whitworth form ISO 228 3/8" |
| Connection type: | Male thread |
| Material: | Brass nickel plated |
| Material description: | Brass CuZn39Pb3 2.0401 (completely) |
| Seal description: | Nitrile-butadiene rubber |
| Surface: | nickel plated |
| Material connection: | Brass nickel plated |
| Material valve body: | Brass nickel plated |
| Material sleeve: | Brass nickel plated |
| Material valve: | Brass |
| Material spring snap ring: | stainless steel AISI 301 |
| Material balls/pins: | Stainless steel AISI 420 |
| Material seal: | Perbunan® |
| Weight in kg: | 0,1171 |
| Self-venting coupling: | No |
| Safety locking system: | Yes |
| Single-hand operation: | No |
| Two-hand operation: | Yes |
| Ball locking: | Yes |
| Pin lock: | No |
| Ultra-FLO-valve: | No |
| Vacuum suitable: | No |
| Water-resistant: | Yes |
| Flat-sealing: | No |
| Suitable breath / respiratory protection: | Yes |
| Pressure eliminator: | No |
| Hydraulics: | No |
| Pneumatics: | Yes |
| Standard product: | No |
| Mould coupling: | No |

Dimensions