

## Datasheet of 26SFTS13MXX6 Plug color coded

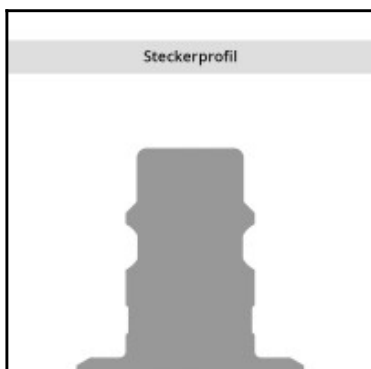
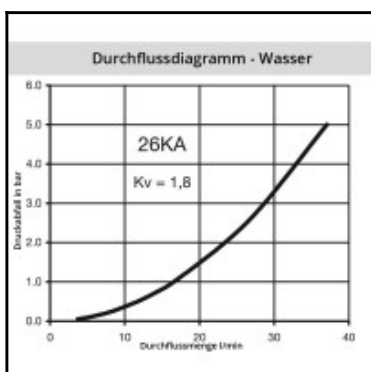
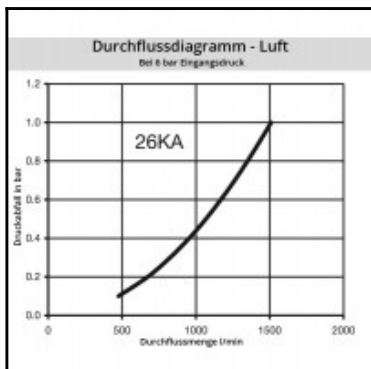
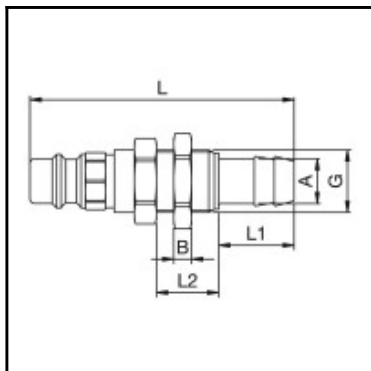

### Description

Plug straight-through, coded system (6 = blue, hexagon), panel mount with hose barb 13mm (1/2), nominal diameter 7,2, <35 bar, brass

Coded industrial coupling system developed on the basis of series 25. Coupling system with single-hand operation. UltraFlo valve for optimum flow and low pressure drop. The mechanical coding of the coupling and plug offers a guarantee for avoiding mix-ups between media when coupling, which is complemented by the color coding of the anodised sleeves. Double shut-off and straightthrough couplings are available upon request. Cannot be interconnected with the Rectus standard 25 series.

### Details

Series:	26
Series long:	26SF
Bore in mm:	7,2
Bore area in mm²:	40
Advantages:	Quality product. One-hand operation. Versatile capability of connections.
Working pressure:	35 bar maximum static working pressure with safety factor 4 to 1.
Working temperature:	-20°C up to +100°C (NBR)
Shut-Off:	Plug Straight-Through
Connection:	Hose barb in Panel mount 13mm LW(1/2")
Connection description:	Hose barb in Panel mount 13mm LW(1/2")
Connection type:	Hose barb
Material:	Brass
Material description:	Brass CuZn39Pb3 2.0401 (except sleeve)
Surface:	blank finish
Coding:	6 = blue, hexagon
Weight in kg:	0,0552
Coded:	Yes
Self-venting coupling:	No
Safety locking system:	No
Single-hand operation:	Yes
Two-hand operation:	No
Ball locking:	No
Pin lock:	No
Ultra-FLO-valve:	No
Vacuum suitable:	Yes
Water-resistant:	Yes
Flat-sealing:	No
Suitable breath / respiratory protection:	No
Pressure eliminator:	No
Hydraulics:	No
Pneumatics:	Yes
Standard product:	No
Mould coupling:	No

### Dimensions

Connection A:	13 mm
B mm:	4
G mm:	M 16 x 1
L mm:	60
L1 mm:	25
L2 mm:	14
SW mm:	17
SW1 mm:	19