

Datasheet of Circuit selector valves - OR VOR 1/4

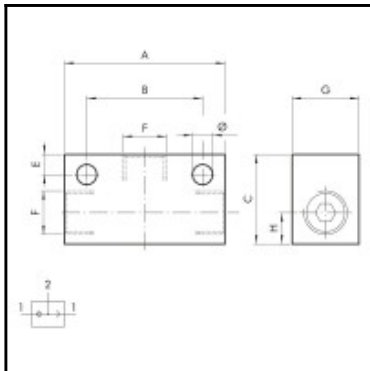

Description

Logic element OR, logic sum, 2 inputs 1 output, 2-10 bar, 1/4" female thread

Circuit selector valves select two separate input signal without creating reciprocal interference, giving a single output signal.

Details

Flow rate in l/min:	1300 (at 6,3 bar)
F:	G 1/8"
Medium suitability:	Filtered, lubricated or unlubricated compressed air. If used, must be continuous.
Connection:	Female thread 1/4"
Working pressure:	2 – 10 bar
Material seal:	NBR
Material body:	Aluminium
Time setting range:	0 – 30s
Shutdown time:	< 0,1s
Repeatability:	± 0,4s
Weight in kg:	0,3

Dimensions

F:	G 1/8"
Ø:	4,5
A mm:	43
B mm:	25
C mm:	25
E mm:	6,5
G mm:	20
H mm:	8,5