

Datasheet of 52SBAW17SVN Plug with male thread

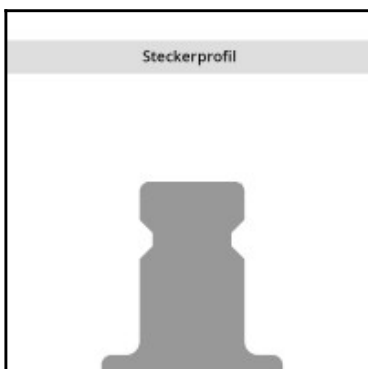
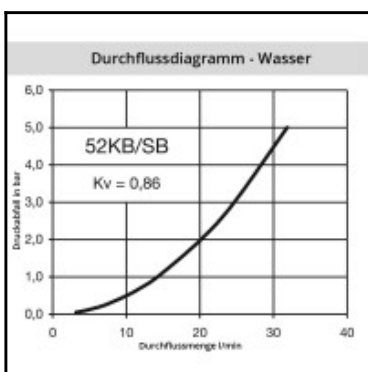
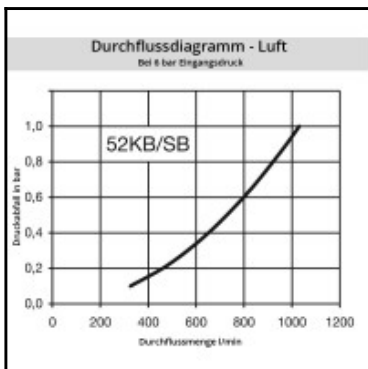
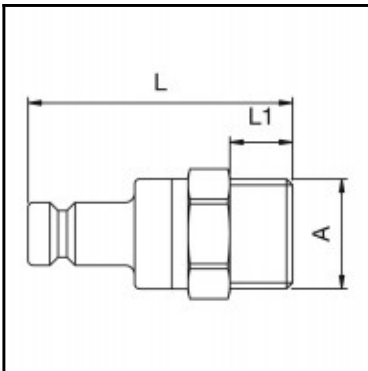

Description

Plug double shut-off, male thread G 3/8, nominal diameter 6, <50 bar, steel nickel plated, seal FKM/FPM

Coupling system with German industrial profile. Coupling system with single-hand operation. UltraFlo valve for optimum flow and low pressure drop. Robust coupling in slim design mainly for pneumatic applications. The steel sleeve counters oscillating forces. The high insertion depth is guaranteed by an optimised plug guide.

Details

| | |
|---|--|
| Series: | 52 |
| Series long: | 52SB |
| Bore in mm: | 6 |
| Bore area in mm²: | 30 |
| Advantages: | Single handed operation. Ergonomic design. High flow valve. |
| Working pressure: | PB = 50 bar maximum static working pressure with safety factor 4 to 1. |
| Working temperature: | -20°C up to +100°C (NBR) -40°C up to +120/150°C (EPDM) -15°C up to +200°C (FKM) depending on the medium. |
| Shut-Off: | Plug Double Shut-Off |
| Connection: | Male thread 3/8" |
| Connection description: | Male pipe thread of Whitworth form ISO 228 3/8" |
| Connection type: | Male thread |
| Material: | Steel nickel-plated |
| Material description: | Steel 9SMnPb28K 1.0718 |
| Seal description: | Fluororubber |
| Surface: | nickel plated |
| Material seal: | Viton® |
| Weight in kg: | 0,057 |
| Self-venting coupling: | No |
| Safety locking system: | No |
| Single-hand operation: | Yes |
| Two-hand operation: | No |
| Ball locking: | No |
| Pin lock: | No |
| Ultra-FLO-valve: | No |
| Vacuum suitable: | Yes |
| Water-resistant: | No |
| Flat-sealing: | No |
| Suitable breath / respiratory protection: | No |
| Pressure eliminator: | No |
| Hydraulics: | No |
| Pneumatics: | Yes |
| Standard product: | No |
| Mould coupling: | No |

Dimensions

| | |
|---------------|-------|
| Connection A: | G 3/8 |
| L mm: | 48 |
| L1 mm: | 9 |
| SW mm: | 22 |