

## Datasheet of 1900SFIW26MXC Plug with female thread

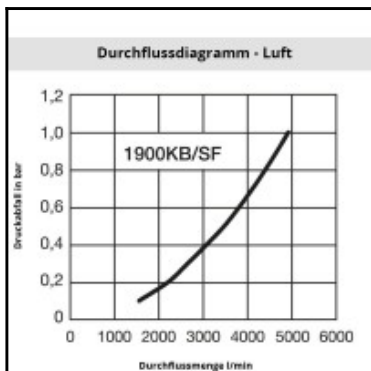
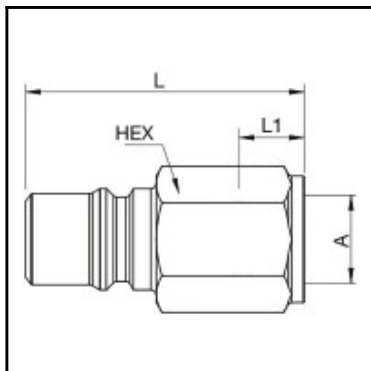

### Description

Plug straight-through, Female thread G 3/4", NW 12,4, <50 bar, brass chrome plated

Robust, corrosion resistant coupling system in brass with high flow values for use with liquids in the pressure range up to 50 bar. Two-hand operation, i.e. both hands are required when connect/disconnect. The main seal of the coupling has a special disc shape, which extends the durability of the coupling. To guarantee greater flexibility, we also offer plugs with no valve.

### Details

Series:	1900
Old order number:	19430 M
Series long:	1900SF
Bore area in mm <sup>2</sup> :	120
Advantages:	High flow. Easy to operate. Long lifetime.
Compatibility:	Tema Design
Working pressure:	PB = 50 bar maximum static working pressure with safety factor 4 to 1.
Working temperature:	-20°C up to +100°C (NBR) -40°C up to +120/150°C (EPDM) -15°C up to +200°C (FKM) depending on the medium.
Shut-Off:	Plug Straight-Through
Connection:	Female thread G 3/4
Connection description:	Female thread G 3/4
Material:	brass, chrome plated
Material description:	Brass CuZn39Pb3 2.0401
Seal description:	Nitrite-butadiene rubber
Surface:	chrome plated
Material seal:	NBR
Weight in kg:	0,124
Self-venting coupling:	No
Safety locking system:	No
Single-hand operation:	No
Two-hand operation:	Yes
Ultra-FLO-valve:	No
Water-resistant:	No
Flat-sealing:	No
Suitable breath / respiratory protection:	No
Pressure eliminator:	No
Hydraulics:	No
Pneumatics:	Yes
Mould coupling:	No

### Dimensions

L mm:	62
L1 mm:	12
SW mm:	30