

## Datasheet of 1800SFTF16SXZ Plug with hose barb

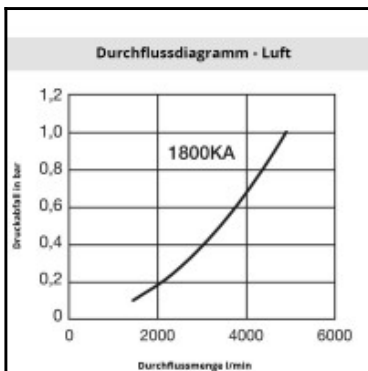
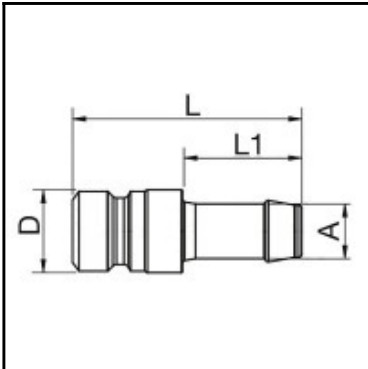

### Description

Plug straight-through, Hose Barb 16 mm, NW 10, <35 bar, steel zinc plated

Series 1800 is used mainly for applications in the area of compressed air and liquids. The coupling system stands out for its robust, compact design and high corrosion resistance. Ultra High Flow valve for optimum flow and low pressure drop.

### Details

Series:	1800
Old order number:	32SFTF16SXZ; 18016
Series long:	1800SF
Bore area in mm²:	80
Advantages:	High flow. Single handed operation. Compact build.
Compatibility:	Rectus 32
Working pressure:	35 bar maximum static working pressure with safety factor 4 to 1.
Working temperature:	-20°C up to +100°C (NBR) -40°C up to +120/150°C (EPDM) -15°C up to +200°C (FKM) depending on the medium.
Shut-Off:	Plug Straight-Through
Connection:	Hose barb 16 mm
Connection description:	Hose barb 16 mm
Material:	Steel, zinc-plated
Material description:	Steel 9SMnPb28K 1.0718
Surface:	zinc plated
Weight in kg:	0,026
Self-venting coupling:	No
Safety locking system:	No
Single-hand operation:	Yes
Two-hand operation:	No
Ultra-FLO-valve:	Yes
Water-resistant:	No
Flat-sealing:	No
Suitable breath / respiratory protection:	No
Pressure eliminator:	No
Hydraulics:	No
Pneumatics:	Yes
Mould coupling:	No

### Dimensions

D mm:	18
L mm:	47
L1 mm:	24