

Datasheet of 1800KBIW21EVX Quick coupling with female thread

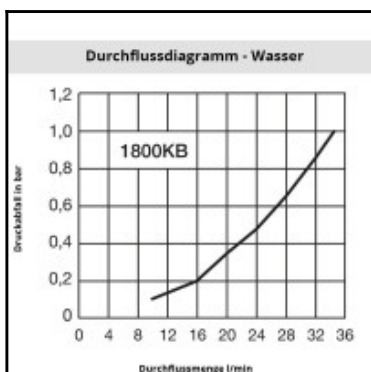
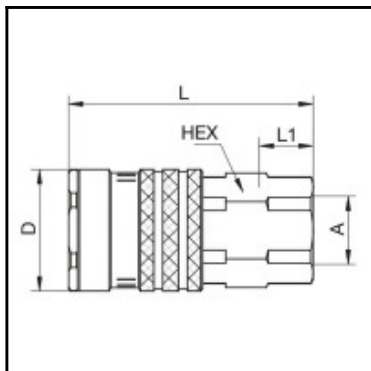

Description

Quick coupling double shut-off, Female thread G 1/2, NW 9,5, <50 bar, stainless steel 1.4404, seal FKM

Series 1800 is used mainly for applications in the area of compressed air and liquids. The coupling system stands out for its robust, compact design and high corrosion resistance. Ultra High Flow valve for optimum flow and low pressure drop.

Details

Series:	1800
Old order number:	1800 NBRV
Series long:	1800KB
Advantages:	High flow. Two-hand operation. Robust and compact build.
Working pressure:	PB = 50 bar maximum static working pressure with safety factor 4 to 1.
Working temperature:	-20°C up to +100°C (NBR) -40°C up to +120/150°C (EPDM) -15°C up to +200°C (FKM) depending on the medium.
Shut-Off:	Quick coupling Double Shut-Off
Connection:	Female thread G 1/2
Connection description:	Female thread G 1/2
Material:	stainless steel AISI 316 L
Material description:	stainless steel 1.4404
Seal description:	Fluororubber
Surface:	blank finish
Material seal:	FKM
Weight in kg:	0,14
Self-venting coupling:	No
Safety locking system:	No
Single-hand operation:	No
Two-hand operation:	Yes
Ultra-FLO-valve:	Yes
Water-resistant:	No
Flat-sealing:	No
Suitable breath / respiratory protection:	No
Pressure eliminator:	No
Hydraulics:	No
Pneumatics:	Yes
Mould coupling:	No

Dimensions

D mm:	27
L mm:	55
L1 mm:	9
SW mm:	24