

## Datasheet of 1800KBIW17MPN Quick coupling with female thread

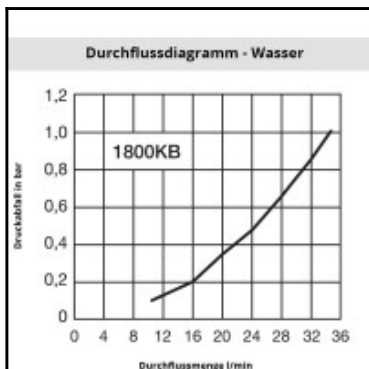
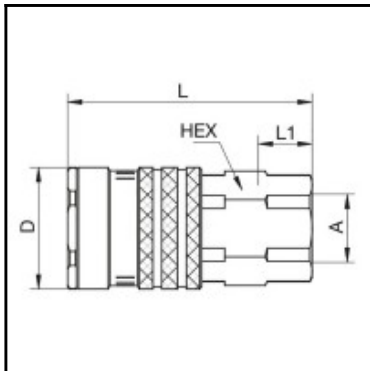

### Description

Quick coupling double shut-off, Female thread G 3/8, NW 10, <50 bar, brass nickel plated, seal NBR

Series 1800 is used mainly for applications in the area of compressed air and liquids. The coupling system stands out for its robust, compact design and high corrosion resistance. Ultra High Flow valve for optimum flow and low pressure drop.

### Details

Series:	1800
Old order number:	1800 N
Series long:	180KB
Bore area in mm²:	80
Advantages:	High flow. Two-hand operation. Compact build.
Working pressure:	PB = 50 bar maximum static working pressure with safety factor 4 to 1.
Working temperature:	-20°C up to +100°C (NBR) -40°C up to +120/150°C (EPDM) -15°C up to +200°C (FKM) depending on the medium.
Shut-Off:	Quick coupling Double Shut-Off
Connection:	Female thread G 3/8
Connection description:	Female thread G 3/8
Material:	Brass, nickel plated
Material description:	Brass CuZn39Pb3 2.0401
Seal description:	Nitrite-butadiene rubber
Surface:	nickel plated
Material seal:	NBR
Weight in kg:	0,125
Self-venting coupling:	No
Safety locking system:	No
Single-hand operation:	No
Two-hand operation:	Yes
Ultra-FLO-valve:	Yes
Water-resistant:	No
Flat-sealing:	No
Suitable breath / respiratory protection:	No
Pressure eliminator:	No
Hydraulics:	No
Pneumatics:	Yes
Mould coupling:	No

### Dimensions

D mm:	27
L mm:	54
L1 mm:	9
SW mm:	22