

## Datasheet of 1800KAIW17MPN Quick coupling with female thread

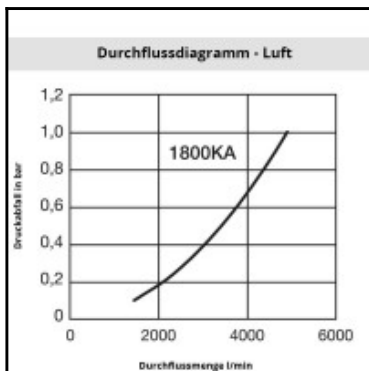
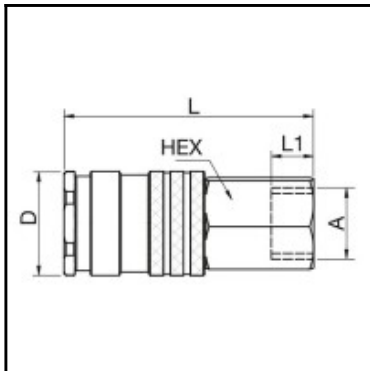

### Description

Quick coupling single shut-off, Female thread G 3/8, NW 10, <35 bar, brass nickel plated, seal NBR

Series 1800 is used mainly for applications in the area of compressed air and liquids. The coupling system stands out for its robust, compact design and high corrosion resistance. Ultra High Flow valve for optimum flow and low pressure drop.

### Details

Series:	1800
Old order number:	32KAIW17MPN; 1800 E
Series long:	1800KA
Bore area in mm²:	80
Advantages:	High flow. Single handed operation. Compact build.
Compatibility:	Rectus 32
Working pressure:	35 bar maximum static working pressure with safety factor 4 to 1.
Working temperature:	-20°C up to +100°C (NBR) -40°C up to +120/150°C (EPDM) -15°C up to +200°C (FKM) depending on the medium.
Shut-Off:	Quick coupling Single Shut-Off
Connection:	Female thread G 3/8
Connection description:	Female thread G 3/8
Material:	Brass, nickel plated
Material description:	Brass CuZn39Pb3 2.0401
Seal description:	Nitrile-butadiene rubber
Surface:	nickel plated
Material seal:	NBR
Weight in kg:	0,162
Self-venting coupling:	No
Safety locking system:	No
Single-hand operation:	Yes
Two-hand operation:	No
Ultra-FLO-valve:	Yes
Water-resistant:	No
Flat-sealing:	No
Suitable breath / respiratory protection:	No
Pressure eliminator:	No
Hydraulics:	No
Pneumatics:	Yes
Mould coupling:	No

### Dimensions

D mm:	27
L mm:	65
L1 mm:	10
SW mm:	23