

Datasheet of 1300SRIW13SXZ Plug with recoil eliminator

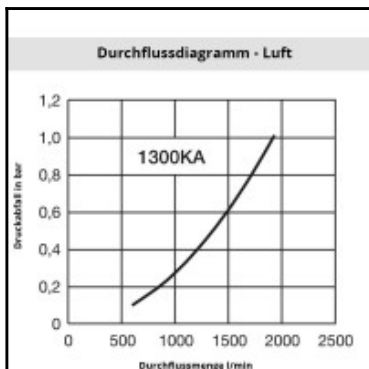
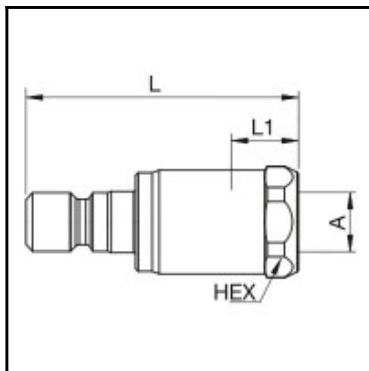

Description

Plug with recoil eliminator, Female thread G 1/4", NW 7,4, <35 bar, steel zinc plated

Series 1300 is used mainly for applications in the area of compressed air and liquids. Optimally suited to smaller to medium-sized pneumatic systems and to compressed air tools. The coupling series stands out for its compact design and high flow rates with the Ultra High Flow valve. Coupling body made of nitrocarburized steel.

Details

Series:	1300
Old order number:	13410 S
Series long:	1300SR
Bore area in mm²:	43
Advantages:	High flow. Single handed operation. Long life of the seal.
Compatibility:	Rectus 31
Working pressure:	30 bar maximum static working pressure with safety factor 4 to 1.
Working temperature:	-20°C up to +100°C (NBR) -40°C up to +120/150°C (EPDM) -15°C up to +200°C (FKM) depending on the medium.
Shut-Off:	Plug Recoil Eliminator
Connection:	Female thread G 1/4
Connection description:	Female thread G 1/4
Material:	Steel, zinc-plated
Material description:	Steel 9SMnPb28K 1.0718
Weight in kg:	0,04
Self-venting coupling:	No
Safety locking system:	No
Single-hand operation:	Yes
Two-hand operation:	No
Ultra-FLO-valve:	Yes
Water-resistant:	No
Flat-sealing:	No
Suitable breath / respiratory protection:	No
Pressure eliminator:	No
Hydraulics:	No
Pneumatics:	Yes
Mould coupling:	No

Dimensions

L mm:	53
L1 mm:	12
SW mm:	20