

## Datasheet of 1300SFTF10SXZ Plug with hose barb

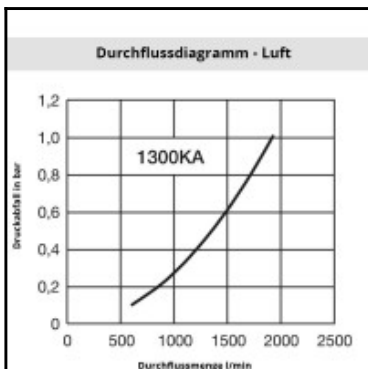
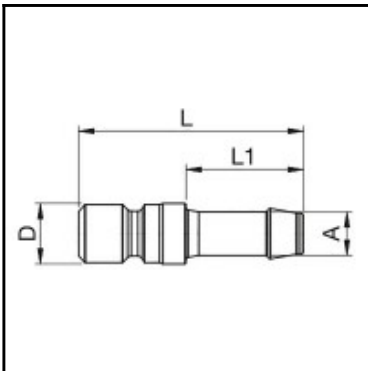
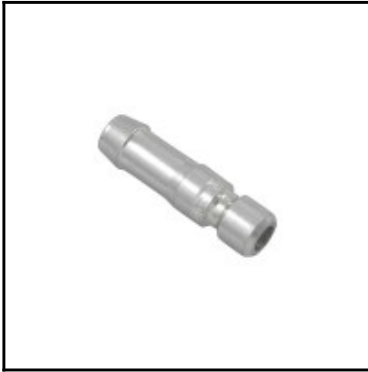

### Description

Plug straight-through, Hose Barb 10 mm, NW 7,4, <35 bar, steel zinc plated

Series 1300 is used mainly for applications in the area of compressed air and liquids. Optimally suited to smaller to medium-sized pneumatic systems and to compressed air tools. The coupling series stands out for its compact design and high flow rates with the Ultra High Flow valve. Coupling body made of nitrocarburized steel.

### Details

Series:	1300
Old order number:	31SFTF10SXZ; 13010-QC
Series long:	1300SF
Bore area in mm <sup>2</sup> :	43
Advantages:	High flow. Single handed operation. Long life of the seal.
Compatibility:	Rectus 31
Working pressure:	30 bar maximum static working pressure with safety factor 4 to 1.
Working temperature:	-20°C up to +100°C (NBR) -40°C up to +120/150°C (EPDM) -15°C up to +200°C (FKM) depending on the medium.
Shut-Off:	Plug Straight-Through
Connection:	Hose barb 10 mm
Connection description:	Hose barb 10 mm
Material:	Steel, zinc-plated
Material description:	Steel 9SMnPb28K 1.0718
Surface:	zinc plated
Weight in kg:	0,02
Self-venting coupling:	No
Safety locking system:	No
Single-hand operation:	Yes
Two-hand operation:	No
Ultra-FLO-valve:	Yes
Water-resistant:	No
Flat-sealing:	No
Suitable breath / respiratory protection:	No
Pressure eliminator:	No
Hydraulics:	No
Pneumatics:	Yes
Mould coupling:	No

### Dimensions

Connection A:	10 mm
D mm:	12
L mm:	44
L1 mm:	24