

## Datasheet of 1300KBIW17MPN Quick coupling with female thread

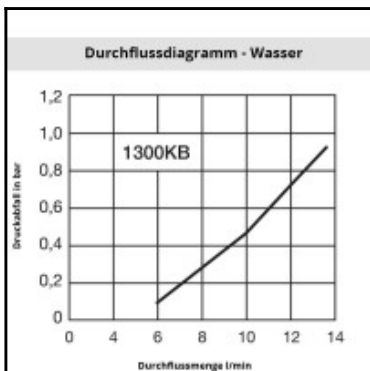
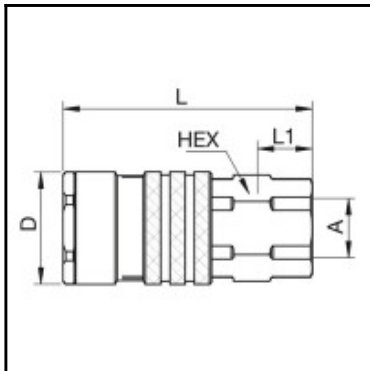

### Description

Quick coupling double shut-off, Female thread G 3/8, NW 7,4, <50 bar, brass nickel plated, seal NBR

Series 1300 is used mainly for applications in the area of compressed air and liquids. Optimally suited to smaller to medium-sized pneumatic systems and to compressed air tools. The coupling series stands out for its compact design and high flow rates with the Ultra High Flow valve. Coupling body made of nitrocarburized steel.

### Details

Series:	1300
Old order number:	1300 NB
Series long:	1300KB
Bore area in mm²:	43
Advantages:	Two-hand operation. Special sealing system in the coupling increases the life of the coupling.
Working pressure:	30 bar maximum static working pressure with safety factor 4 to 1.
Working temperature:	-20°C up to +100°C (NBR) -40°C up to +120/150°C (EPDM) -15°C up to +200°C (FKM) depending on the medium.
Shut-Off:	Quick coupling Double Shut-Off
Connection:	Female thread G 3/8
Connection description:	Female thread G 3/8
Material:	Brass, nickel plated
Material description:	Brass CuZn39Pb3 2.0401
Seal description:	Nitrite-butadiene rubber
Surface:	nickel plated
Material seal:	NBR
Weight in kg:	0,086
Self-venting coupling:	No
Safety locking system:	No
Single-hand operation:	No
Two-hand operation:	Yes
Ultra-FLO-valve:	Yes
Water-resistant:	No
Flat-sealing:	No
Suitable breath / respiratory protection:	No
Pressure eliminator:	No
Hydraulics:	No
Pneumatics:	Yes
Mould coupling:	No

### Dimensions

D mm:	22
L mm:	50
L1 mm:	8
SW mm:	18