

Datasheet of 1300KBIW13EVX Quick coupling with female thread

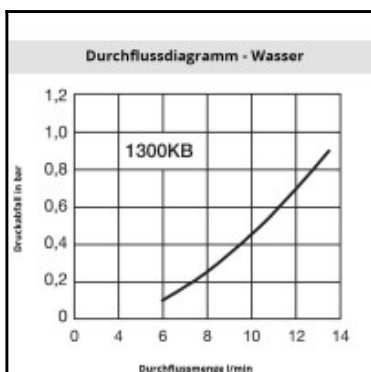
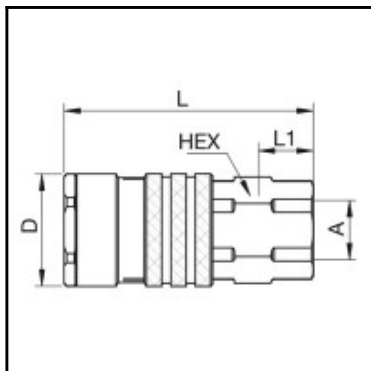

Description

Quick coupling double shut-off, Male thread G 1/4, NW 6,8, <50 bar, stainless steel 1.4404, seal FKM

Series 1300 is used mainly for applications in the area of compressed air and liquids. Optimally suited to smaller to medium-sized pneumatic systems and to compressed air tools. The coupling series stands out for its compact design and high flow rates with the Ultra High Flow valve. Coupling body made of nitrocarburized steel.

Details

Series:	1300
Old order number:	1300 NRV
Series long:	1300KB
Bore area in mm²:	43
Advantages:	High flow. Two-hand operation.
Working pressure:	PB = 50 bar maximum static working pressure with safety factor 4 to 1.
Working temperature:	-20°C up to +100°C (NBR) -40°C up to +120/150°C (EPDM) -15°C up to +200°C (FKM) depending on the medium.
Shut-Off:	Quick coupling Double Shut-Off
Connection:	Male thread G 1/4
Connection description:	Male thread G 1/4
Material:	stainless steel AISI 316 L
Material description:	stainless steel 1.4404
Seal description:	Fluororubber
Surface:	blank finish
Material seal:	FKM
Weight in kg:	0,083
Self-venting coupling:	No
Safety locking system:	No
Single-hand operation:	No
Two-hand operation:	Yes
Ultra-FLO-valve:	Yes
Water-resistant:	Yes
Flat-sealing:	No
Suitable breath / respiratory protection:	No
Pressure eliminator:	No
Hydraulics:	No
Pneumatics:	Yes
Mould coupling:	No

Dimensions

D mm:	22
L mm:	49
L1 mm:	8
SW mm:	18