

## Datasheet of 1300KAAK17MPN Quick coupling with male thread

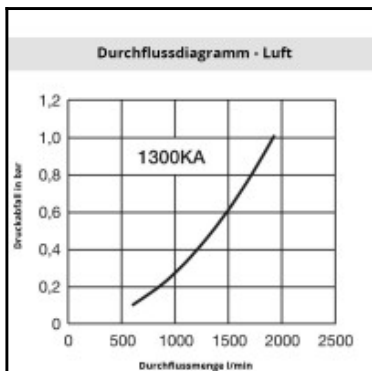
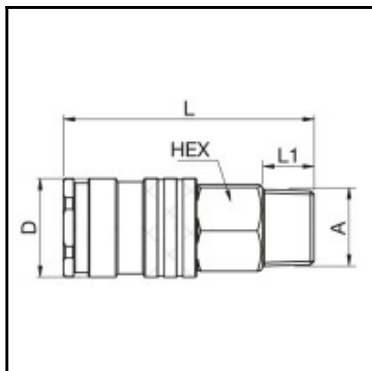

### Description

Quick coupling single shut-off, Male thread R 3/8, NW 7,4, <35 bar, brass nickel plated, seal NBR

Series 1300 is used mainly for applications in the area of compressed air and liquids. Optimally suited to smaller to medium-sized pneumatic systems and to compressed air tools. The coupling series stands out for its compact design and high flow rates with the Ultra High Flow valve. Coupling body made of nitrocarburized steel.

### Details

Series:	1300
Old order number:	31KAAK17SPN; 1300 EA
Series long:	1300KA
Bore area in mm²:	43
Advantages:	High flow. Single handed operation. Long life of the seal.
Compatibility:	Rectus 31
Working pressure:	30 bar maximum static working pressure with safety factor 4 to 1.
Working temperature:	-20°C up to +100°C (NBR) -40°C up to +120/150°C (EPDM) -15°C up to +200°C (FKM) depending on the medium.
Shut-Off:	Quick coupling Single Shut-Off
Connection:	Male thread R 3/8
Connection description:	Male thread R 3/8
Material:	Brass, nickel plated
Material description:	Brass CuZn39Pb3 2.0401
Seal description:	Nitrite-butadiene rubber
Surface:	nickel plated
Material seal:	NBR
Weight in kg:	0,088
Self-venting coupling:	No
Safety locking system:	No
Single-hand operation:	Yes
Two-hand operation:	No
Ultra-FLO-valve:	Yes
Water-resistant:	No
Flat-sealing:	No
Suitable breath / respiratory protection:	No
Pressure eliminator:	No
Hydraulics:	No
Pneumatics:	Yes
Mould coupling:	No

### Dimensions

D mm:	22
L mm:	56
L1 mm:	12
SW mm:	19