

Datasheet of 1100SAW10SXZ Plug with male thread

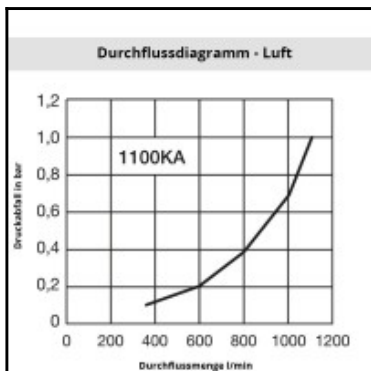
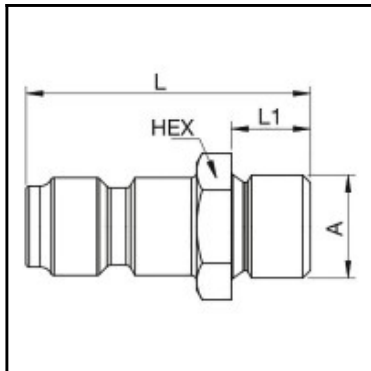

Description

Plug straight-through, Male thread G 1/8", NW 5,5, <30 bar, steel zinc plated

Robust design with small dimensions. Series 1100 is used mainly for applications in the area of compressed air and liquids. Optimally suited to smaller pneumatic systems and to compressed air tools with a consumption of up to 900 litres per minute. Coupling systems with two-hand operation, i.e. both hands are required when connect/disconnect.

Details

Series:	1100
Old order number:	11110-QC
Series long:	1100SF
Bore area in mm ² :	24
Advantages:	Robust structure. Small dimensions.
Compatibility:	Tema Design
Working pressure:	30 bar maximum static working pressure with safety factor 4 to 1.
Working temperature:	-20°C up to +100°C (NBR) -40°C up to +120/150°C (EPDM) -15°C up to +200°C (FKM) depending on the medium.
Shut-Off:	Plug Straight-Through
Connection:	Male thread G 1/8
Connection description:	Male thread G 1/8
Material:	Steel, zinc-plated
Material description:	Steel 9SMnPb28K 1.0718
Surface:	zinc plated
Material connection:	Steel, zinc-plated
Weight in kg:	0,01
Self-venting coupling:	No
Safety locking system:	No
Single-hand operation:	No
Two-hand operation:	Yes
Ultra-FLO-valve:	No
Water-resistant:	No
Flat-sealing:	No
Suitable breath / respiratory protection:	No
Pressure eliminator:	No
Hydraulics:	No
Pneumatics:	Yes
Mould coupling:	No

Dimensions

L mm:	27
L1 mm:	7,5
SW mm:	12