

## Datasheet of 1100KAIW10MPC Quick coupling with female thread

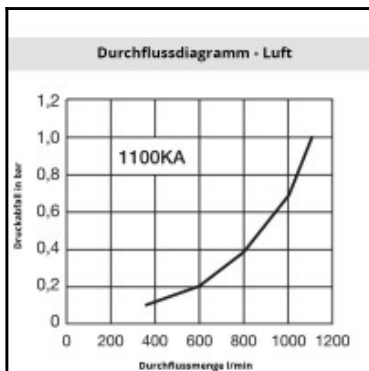
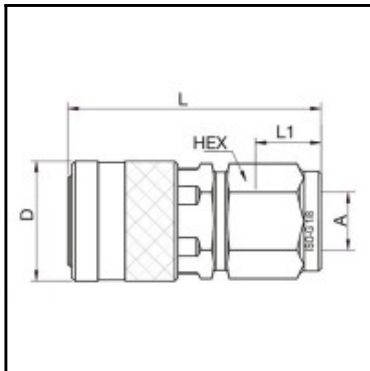

### Description

Quick coupling single shut-off, Female thread G 1/8, NW 5,5, <30 bar, brass chrome plated, seal NBR

Robust design with small dimensions. Series 1100 is used mainly for applications in the area of compressed air and liquids. Optimally suited to smaller pneumatic systems and to compressed air tools with a consumption of up to 900 litres per minute. Coupling systems with two-hand operation, i.e. both hands are required when connect/disconnect.

### Details

Series:	1100
Old order number:	1100
Series long:	1100KA
Bore area in mm²:	24
Advantages:	Robust structure. Small dimensions.
Compatibility:	Tema Design
Working pressure:	30 bar maximum static working pressure with safety factor 4 to 1.
Working temperature:	-20°C up to +100°C (NBR) -40°C up to +120/150°C (EPDM) -15°C up to +200°C (FKM) depending on the medium.
Shut-Off:	Quick coupling Single Shut-Off
Connection:	Female thread G 1/8
Connection description:	Female thread G 1/8
Material:	brass, chrome plated
Material description:	Brass CuZn39Pb3 2.0401
Seal description:	Nitrite-butadiene rubber
Surface:	chrome plated
Material connection:	brass chrome plated
Material valve body:	brass chrome plated
Material sleeve:	brass chrome plated
Material seal:	NBR
Weight in kg:	0,045
Self-venting coupling:	No
Safety locking system:	No
Single-hand operation:	No
Two-hand operation:	Yes
Ultra-FLO-valve:	No
Water-resistant:	Yes
Flat-sealing:	No
Suitable breath / respiratory protection:	No
Pressure eliminator:	No
Hydraulics:	No
Pneumatics:	Yes
Mould coupling:	No

### Dimensions

D mm:	18
L mm:	38
L1 mm:	8
SW mm:	15