

Datasheet of 25SLKO10RVX Plug with hose nut

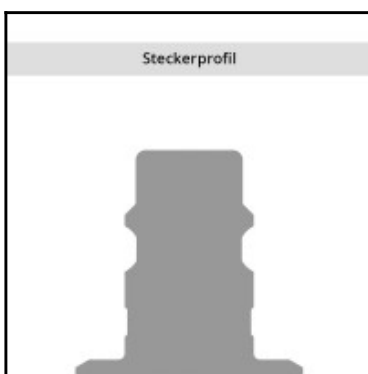
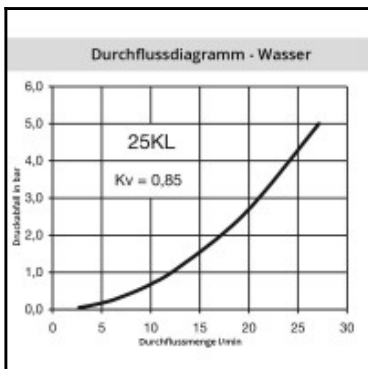
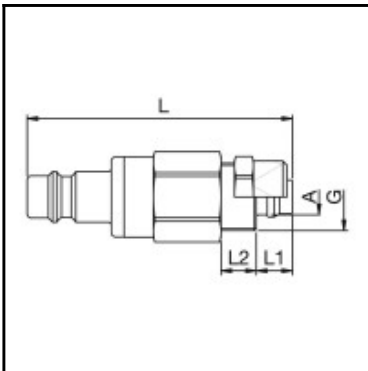

Description

Plug dry-break double shut-off, with hose nut 8 x 10 mm, nominal diameter 7,4, <8 bar, stainless steel AISI 303, seal FKM

Universal industrial coupling with standard European profile for use with gaseous, liquid and aggressive medio. Coupling system with single-hand operation. UltraFlo valve for optimum flow and low pressure drop. The series stands out for its robust design and long service life even with the harshest use. The collar design minimises damage to the valve body.

Details

Series:	25
Series long:	25SL
Bore in mm:	7,4
Bore area in mm²:	42
Advantages:	One-hand operation. Robust structure. UltraFlo valve. The collar design minimises damage to the valve body. Minimal, almost imperceptible leakage when uncoupling. No air locked into the system during the coupling process.
Working pressure:	PB = 8 bar maximum static working pressure with safety factor 4 to 1.
Working temperature:	-20°C up to +100°C (NBR) -40°C up to +120/150°C (EPDM) -15°C up to +200°C (FKM) depending on the medium.
Shut-Off:	Plug Dry-Break (double shut-off)
Connection:	with tube nut 8 x 10 mm
Connection description:	with tube nut 8 x 10 mm
Connection type:	Connection nut
Material:	stainless steel AISI 303
Material description:	stainless steel AISI 303
Seal description:	Fluororubber
Surface:	blank finish
Material connection:	stainless steel AISI 303
Material valve:	stainless steel AISI 303
Material spring snap ring:	stainless steel AISI 301
Material seal:	Viton®
Weight in kg:	0,0646
Self-venting coupling:	No
Safety locking system:	No
Single-hand operation:	Yes
Two-hand operation:	No
Ball locking:	No
Pin lock:	No
Ultra-FLO-valve:	No
Vacuum suitable:	No
Water-resistant:	No
Flat-sealing:	No
Suitable breath / respiratory protection:	No
Pressure eliminator:	No
Hydraulics:	No
Pneumatics:	Yes
Standard product:	No
Mould coupling:	No

Dimensions

Connection A:	8 x 10 mm
G mm:	M 16 x 1
L mm:	63
L1 mm:	8,5
L2 mm:	8,5
SW mm:	19