

Datasheet of FEM-1002-16FB Hydraulic plug

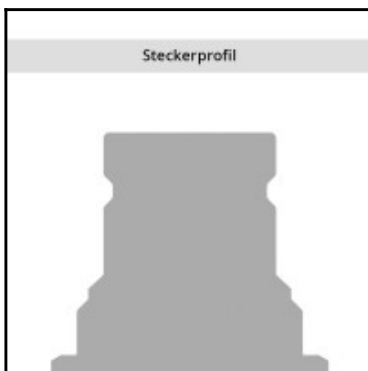
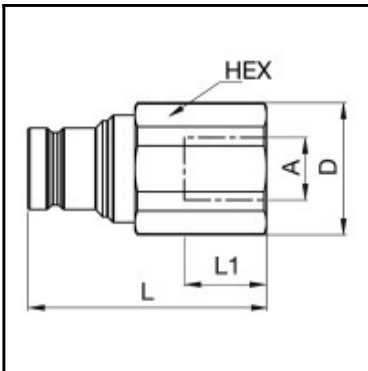

Description

Hydraulic plug double shut-off, female thread G 1", nominal diameter 25, 200 bar, steel, seal NBR

The FEM, FEC and IF series plug profile are produced according to ISO Standard 16028 and are compatible with other series complying with the same standard. These couplings offer a leakage free disconnection – minimal oil loss during uncoupling. Thanks to the valve design, the coupling has a minimum pressure drop, and thus achieves maximum cost-effectiveness. Exists in standard version (steel) and stainless steel.

Details

Series:	FEM/IF
Old order number:	IF10020
Series long:	IF10000
Bore in mm:	25
Bore area in mm²:	490
Size in general:	1"
Advantages:	Can be operated with use of one hand and with Safety locking feature to prevent unintentional uncoupling.
Coupled working pressure in bar:	200
Working temperature:	-30°C up to +100°C (NBR) -25°C up to +200°C (FKM) depending on the medium.
Shut-Off:	Plug Double Shut-Off
Connection:	Female thread 1"
Connection type:	Female thread
Material:	Steel
Surface:	zinc plated, passivated, sealed
Material valve body:	steel hardened
Material valve:	Steel
Material valve holder:	Brass
Material spring snap ring:	1.4310
Weight in kg:	0,8
Safety locking system:	Yes
Single-hand operation:	Yes
Two-hand operation:	No
Ball locking:	Yes
Vacuum suitable:	No
Flat-sealing:	No
Pressure eliminator:	No
Hydraulics:	Yes

Dimensions

Connection A:	G 1"
D mm:	60
L mm:	89
L1 mm:	18
SW mm:	55