

Datasheet of 233G0240 Cartridge pressure regulator

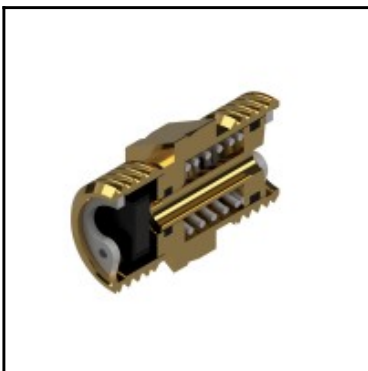
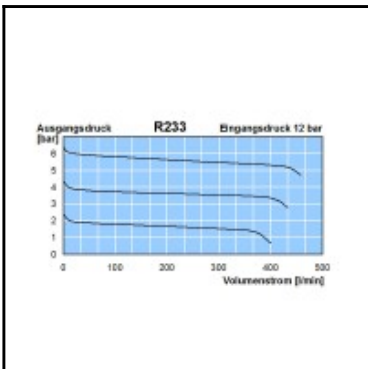
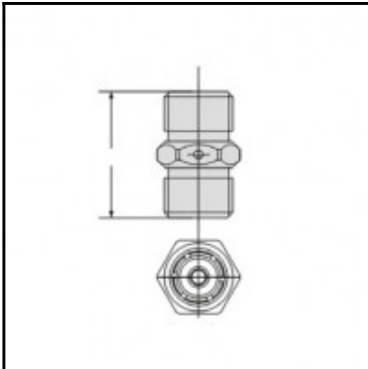

Description

Cartridge pressure regulator, outlet pressure 4 bar, supply pressure 12 bar, male thread G 1/4, Brass

Cartridge pressure regulator suitable for assembly block.

Select the pressure regulator according to the desired outlet pressure. The outlet pressure cannot be subsequently adjusted. This safeguards against tampering.

Details

Series:	233
Flow rate in l/min:	350
Series long:	233
max. inlet pressure:	12 bar
Outlet pressure:	4 bar
Relieving function:	non-relieving
Working temperature:	-20°C up to +60°C
Connection:	Male thread G 1/4
Connection description:	Male thread G 1/4
Material:	Brass
Seal description:	Nitrite-butadiene rubber
Surface:	blank finish
Material connection:	Brass
Material seal:	NBR
Case:	Brass
Filter element:	Stainless steel
Tappet:	Brass
Medium suitability:	compressed air or non-corrosive gases
Weight in kg:	0,02
Hydraulics:	No
Pneumatics:	Yes
Water-resistant:	No

Dimensions

Connection A:	G 1/4
A mm:	24
SW mm:	14