

## Datasheet of 233G0220 Cartridge pressure regulator

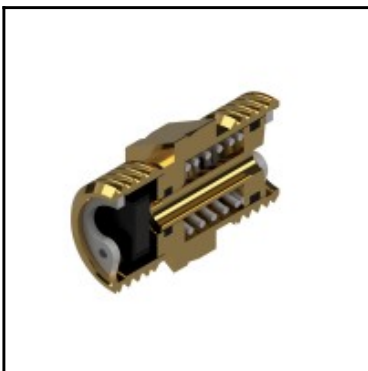
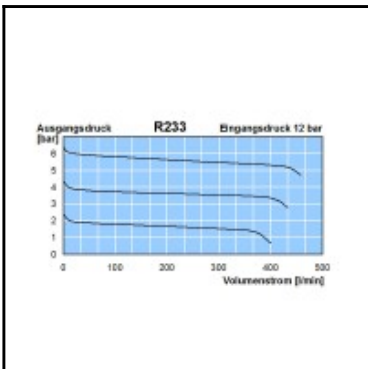
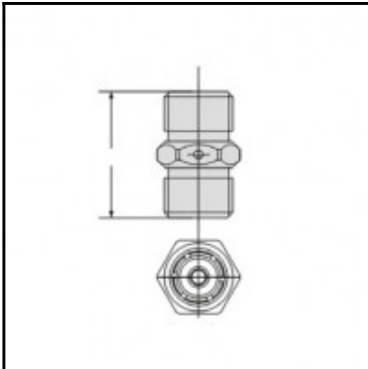

### Description

Cartridge pressure regulator, outlet pressure 2 bar, supply pressure 12 bar, male thread G 1/4, Brass

Cartridge pressure regulator suitable for assembly block.

Select the pressure regulator according to the desired outlet pressure. The outlet pressure cannot be subsequently adjusted. This safeguards against tampering.

### Details

Series:	233
Flow rate in l/min:	350
Series long:	233
max. inlet pressure:	12 bar
Outlet pressure:	2 bar
Relieving function:	non-relieving
Working temperature:	-20°C up to +60°C
Connection:	Male thread G 1/4
Connection description:	Male thread G 1/4
Material:	Brass
Seal description:	Nitrite-butadiene rubber
Surface:	blank finish
Material connection:	Brass
Material seal:	NBR
Case:	Brass
Filter element:	Stainless steel
Tappet:	Brass
Medium suitability:	compressed air or non-corrosive gases
Weight in kg:	0,02
Hydraulics:	No
Pneumatics:	Yes
Water-resistant:	No

### Dimensions

Connection A:	G 1/4
A mm:	24
SW mm:	14