

Datasheet of 9065811 – IN-LINE STOP VALVE pipe-thread Ø8-1/4

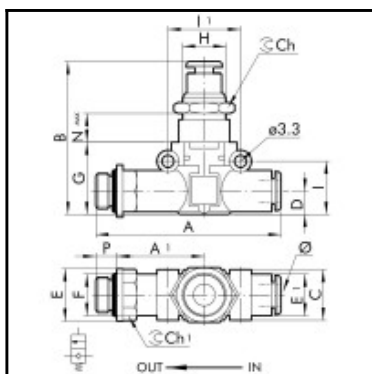

Description

Inline stop valve, pipe-thread, Ø8-1/4, 10 bar

The STP L stop valve belongs to the LINE ON LINE® family and can be connected in series or in parallel with the other products in the same family.

It is available in a version for pipe-pipe connection, which includes two push-in fittings, and a version for thread-pipe connection, which includes a nickel-plated brass male thread and a push-in fitting.

The stop valve is normally mounted on the inlet port of cylinders and allows the flow of air only in the presence of a pneumatic pilot. Cylinder movement ceases if there is a drop in pneumatic pilot pressure.

The compressed air port is a push-in fitting for Ø 4 pipe.

This stop valve is available in a unidirectional version, so the flow can be interrupted in one direction, but remains free in the other direction.

This valve can also be used as a unidirectional normally-closed 2/2 pneumatic control valve.

Details

| | |
|----------------------------------|--|
| F: | 1/4 |
| B: | 49,7 |
| C: | 18,7 |
| Ch1: | 14 |
| E: | 18 |
| E1: | 13,8 |
| G: | 26 |
| H: | M15x1 |
| N: | 4 |
| Medium suitability: | Lubricated or unlubricated filtered air. |
| Working temperature: | -20 – +60 °C |
| Maximum working pressure in bar: | 10 bar |
| Recommended pipe: | Rilsan PA 11 – Nylon 6 – Polyamid 12 – Polypropylen. |
| Weight in kg: | 0,074 |

Dimensions

| | |
|---------------|---|
| Connection 1: | Push-in fitting 8 mm outside calibrated |
| Connection 2: | Male thread G 1/4 |
| F: | 1/4 |
| Ø: | 8 |
| A: | 70,6 |
| A1: | 34,2 |
| B: | 49,7 |
| C: | 18,7 |
| Ch: | 17 |
| Ch1: | 14 |
| D: | 9,1 |
| E: | 18 |
| E1: | 13,8 |
| G: | 26 |
| H: | M15x1 |
| I: | 18,7 |
| I1: | 24 |
| P: | 8 |
| N: | 4 |