

## Datasheet of 9065809 – IN-LINE STOP VALVE pipe-thread Ø6-1/4

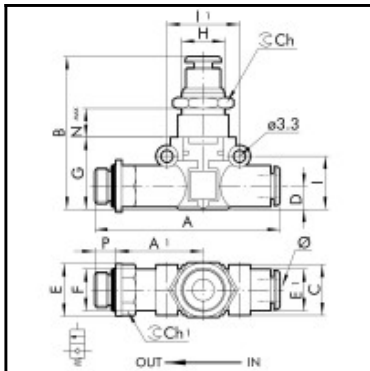

### Description

Inline stop valve, pipe-thread, Ø6-1/4, 10 bar

The STP L stop valve belongs to the LINE ON LINE® family and can be connected in series or in parallel with the other products in the same family.

It is available in a version for pipe-pipe connection, which includes two push-in fittings, and a version for thread-pipe connection, which includes a nickel-plated brass male thread and a push-in fitting.

The stop valve is normally mounted on the inlet port of cylinders and allows the flow of air only in the presence of a pneumatic pilot. Cylinder movement ceases if there is a drop in pneumatic pilot pressure.

The compressed air port is a push-in fitting for Ø 4 pipe.

This stop valve is available in a unidirectional version, so the flow can be interrupted in one direction, but remains free in the other direction.

This valve can also be used as a unidirectional normally-closed 2/2 pneumatic control valve.

### Details

F:	1/4
B:	43,2
C:	14,7
Ch1:	14
E:	18
E1:	11,4
G:	20
H:	M12x0,75
N:	4,7
Medium suitability:	Lubricated or unlubricated filtered air.
Working temperature:	-20 – +60 °C
Maximum working pressure in bar:	10 bar
Recommended pipe:	Rilsan PA 11 – Nylon 6 – Polyamid 12 – Polypropylen.
Weight in kg:	0,051

### Dimensions

Connection 1:	Push-in fitting 6 mm outside calibrated
Connection 2:	Male thread G 1/4
F:	1/4
Ø:	6
A:	61,5
A1:	28,8
B:	43,2
C:	14,7
Ch:	15
Ch1:	14
D:	6,4
E:	18
E1:	11,4
G:	20
H:	M12x0,75
I:	14,6
I1:	20
P:	8
N:	4,7