

## Datasheet of 6888 10 00 Plug-in equal branch tee

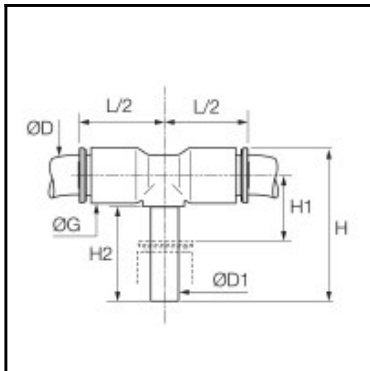

### Description

Plug-in equal branch tee CleanFit®, Biobased raw materials, 10 mm, 10 mm

Connection of 2 tubes at a 90° angle with another push-in fitting or cartridge  
Robust eco-conception, aesthetic design and superior level of cleanliness for a perfect compatibility  
Airtight, antistatic packaging

Full flow

100 % leak-tested, date coding to guarantee quality and traceability

ASTM G93-03 B 300, ISO 15001, VDI 2083

Conform to CGA G4.1 and DI93/42/EC

### Details

ØD:	10 mm
ØD1:	10 mm
G:	16
H:	41
H1:	9,5
H2:	24,5
L2:	26,5
Maximum working pressure in bar:	15
Material seal:	EPDM
Material body:	Biobased raw materials
Material toothed washer:	Stainless steel
min. temperature in °C:	-10
max. temperature in °C:	95
Vacuum resistance in mm Hg:	755
Material:	Biobased raw materials
RoHS compliant:	Yes
Weight in kg:	0,007

### Dimensions

ØD:	10 mm
ØD1:	10 mm
G:	16
H:	41
H1:	9,5
H2:	24,5
L2:	26,5