

## Datasheet of 6888 04 00 Plug-in equal branch tee

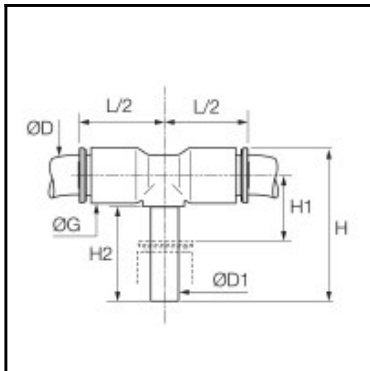

### Description

Plug-in equal branch tee CleanFit®, Biobased raw materials, 4 mm, 4 mm

Connection of 2 tubes at a 90° angle with another push-in fitting or cartridge

Robust eco-conception, aesthetic design and superior level of cleanliness for a perfect compatibility

Airtight, antistatic packaging

Full flow

100 % leak-tested, date coding to guarantee quality and traceability

ASTM G93-03 B 300, ISO 15001, VDI 2083

Conform to CGA G4.1 and DI93/42/EC

### Details

ØD:	4 mm
ØD1:	4 mm
G:	8,5
H:	25
H1:	6
H2:	15,5
L2:	15
Maximum working pressure in bar:	15
Material seal:	EPDM
Material body:	Biobased raw materials
Material toothed washer:	Stainless steel
min. temperature in °C:	-10
max. temperature in °C:	95
Vacuum resistance in mm Hg:	755
Material:	Biobased raw materials
RoHS compliant:	Yes
Weight in kg:	0,005

### Dimensions

ØD:	4 mm
ØD1:	4 mm
G:	8,5
H:	25
H1:	6
H2:	15,5
L2:	15