

Datasheet of 6816 12 00 Equal bulkhead connector

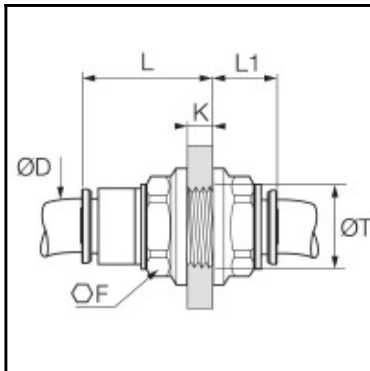

Description

Equal bulkhead connector CleanFit®, Biobased raw materials, 12 mm

Connects 2 tubes through a panel, providing optimum sealing between the fitting and the panel
Robust eco-conception, aesthetic design and superior level of cleanliness for a perfect compatibility
Airtight, antistatic packaging

Full flow

100 % leak-tested, date coding to guarantee quality and traceability

ASTM G93-03 B 300, ISO 15001, VDI 2083

Conform to CGA G4.1 and DI93/42/EC

Details

ØD:	12 mm
F:	26
K max:	18,5
L:	35
L1:	15,5
T min:	22,5
Maximum working pressure in bar:	15
Material seal:	EPDM
Material body:	Biobased raw materials
Material stem:	Biobased raw materials
Material toothed washer:	Stainless steel
min. temperature in °C:	-10
max. temperature in °C:	95
Vacuum resistance in mm Hg:	755
Material:	Biobased raw materials
RoHS compliant:	Yes
Weight in kg:	0,02

Dimensions

ØD:	12 mm
F:	26
K max:	18,5
L:	35
L1:	15,5
T min:	22,5