

## Datasheet of 6808 12 21 Stud branch tee

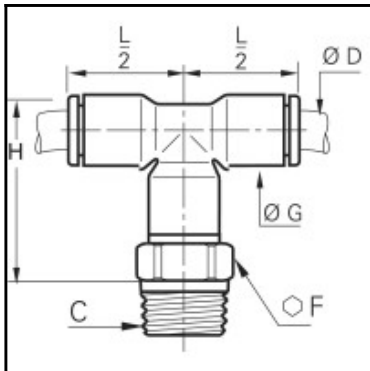

### Description

Stud branch tee CleanFit®, Biobased raw materials, 12 mm, R1/2"

Connection of 2 tubes at a 90° angle to a threaded port. Tightened on the top of the fitting with a flat spanner or socket wrench

Robust eco-conception, aesthetic design and superior level of cleanliness for a perfect compatibility  
Airtight, antistatic packaging

Full flow

100 % leak-tested, date coding to guarantee quality and traceability

ASTM G93-03 B 300, ISO 15001, VDI 2083

Conform to CGA G4.1 and DI93/42/EC

### Details

|                                  |  |
|----------------------------------|--|
| ØD:                              | 12 mm                                  |
| C:                               | R1/2"                                  |
| F:                               | 21                                     |
| G:                               | 19                                     |
| H:                               | 45                                     |
| L2:                              | 31                                     |
| Maximum working pressure in bar: | 15                                     |
| Material seal:                   | EPDM                                   |
| Material body:                   | Biobased raw materials                 |
| Material threaded fitting:       | Brass nickel plated chemical fda brass |
| Material toothed washer:         | Stainless steel                        |
| min. temperature in °C:          | -10                                    |
| max. temperature in °C:          | 95                                     |
| Vacuum resistance in mm Hg:      | 755                                    |
| Material:                        | Biobased raw materials                 |
| RoHS compliant:                  | Yes                                    |
| Weight in kg:                    | 0,041                                  |

### Dimensions

|     |       |
|-----|-------|
| ØD: | 12 mm |
| C:  | R1/2" |
| F:  | 21    |
| G:  | 19    |
| H:  | 45    |
| L2: | 31    |