

Datasheet of 6808 04 13 Stud branch tee

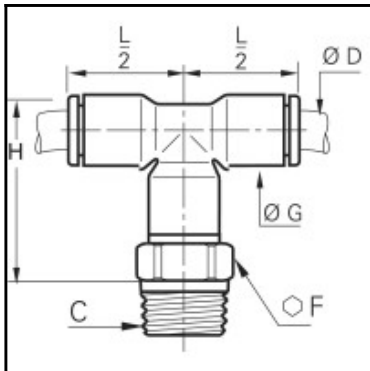

Description

Stud branch tee CleanFit®, Biobased raw materials, 4 mm, R1/4"

Connection of 2 tubes at a 90° angle to a threaded port. Tightened on the top of the fitting with a flat spanner or socket wrench

Robust eco-conception, aesthetic design and superior level of cleanliness for a perfect compatibility
Airtight, antistatic packaging

Full flow

100 % leak-tested, date coding to guarantee quality and traceability

ASTM G93-03 B 300, ISO 15001, VDI 2083

Conform to CGA G4.1 and DI93/42/EC

Details

| | |
|----------------------------------|--|
| ØD: | 4 mm |
| C: | R1/4" |
| F: | 14 |
| G: | 8,5 |
| H: | 23 |
| L2: | 14 |
| Maximum working pressure in bar: | 15 |
| Material seal: | EPDM |
| Material body: | Biobased raw materials |
| Material threaded fitting: | Brass nickel plated chemical fda brass |
| Material toothed washer: | Stainless steel |
| min. temperature in °C: | -10 |
| max. temperature in °C: | 95 |
| Vacuum resistance in mm Hg: | 755 |
| Material: | Biobased raw materials |
| RoHS compliant: | Yes |
| Weight in kg: | 0,017 |

Dimensions

| | |
|-----|-------|
| ØD: | 4 mm |
| C: | R1/4" |
| F: | 14 |
| G: | 8,5 |
| H: | 23 |
| L2: | 14 |