

Datasheet of 25SFTS06RXX Plug for panel mount with hose barb

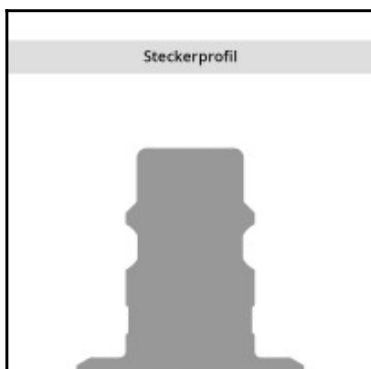
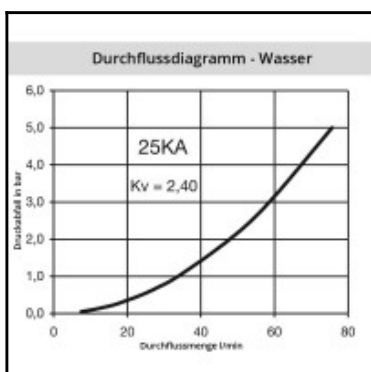
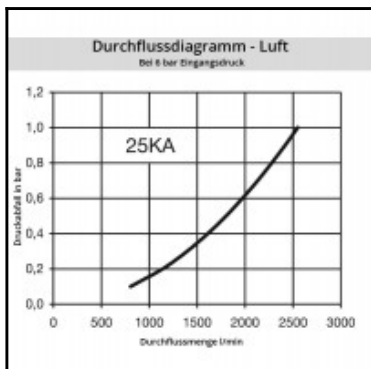
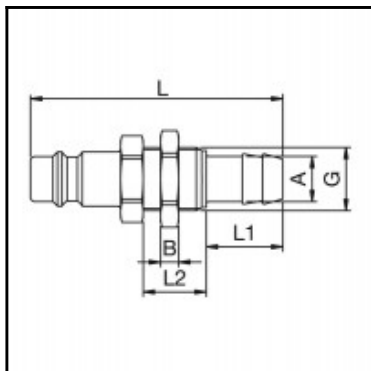

Description

Plug straight-through, panel mount with hose barb 6mm (1/4), nominal diameter 7,8, <35 bar, stainless steel AISI 303

Universal industrial coupling with standard European profile for use with gaseous, liquid and aggressive media. Coupling system with single-hand operation. UltraFlo valve for optimum flow and low pressure drop. The series stands out for its robust design and long service life even with the harshest use. The collar design minimises damage to the valve body.

Details

| | |
|---|--|
| Series: | 25 |
| Series long: | 25SF |
| Bore in mm: | 7,8 |
| Bore area in mm²: | 48 |
| Advantages: | One-hand operation. Robust structure. UltraFlo valve. |
| Compatibility: | RECTUS 26 European standard profiles |
| Working pressure: | 35 bar maximum static working pressure with safety factor 4 to 1. |
| Working temperature: | -20°C up to +100°C (NBR) -40°C up to +120/150°C (EPDM) -15°C up to +200°C (FKM) depending on the medium. |
| Shut-Off: | Plug Straight-Through |
| Connection: | Hose barb in Panel mount 6mm LW(1/4") |
| Connection description: | Hose barb in Panel mount 6mm LW(1/4") |
| Connection type: | Hose barb |
| Material: | stainless steel AISI 303 |
| Material description: | stainless steel AISI 303 |
| Surface: | blank finish |
| Weight in kg: | 0,0253 |
| Self-venting coupling: | No |
| Safety locking system: | No |
| Single-hand operation: | Yes |
| Two-hand operation: | No |
| Ball locking: | No |
| Pin lock: | No |
| Ultra-FLO-valve: | No |
| Vacuum suitable: | No |
| Water-resistant: | Yes |
| Flat-sealing: | No |
| Suitable breath / respiratory protection: | No |
| Pressure eliminator: | No |
| Hydraulics: | No |
| Pneumatics: | Yes |
| Standard product: | No |
| Mould coupling: | No |

Dimensions

| | |
|---------------|----------|
| Connection A: | 6 mm |
| B mm: | 4 |
| G mm: | M 12 x 1 |
| L mm: | 56 |
| L1 mm: | 17 |
| L2 mm: | 14 |
| SW mm: | 14 |
| SW1 mm: | 17 |