

Datasheet of 6875 04 10 Stud fitting

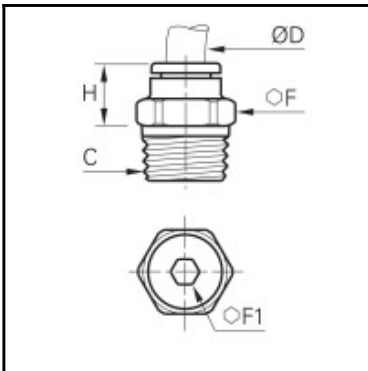

Description

Stud fitting CleanFit®, Biobased raw materials, 4 mm, R1/8"

In-line connection of tubing to a threaded port. External tightening with a flat spanner or socket wrench, internal adjustment with an Allen key

Robust eco-conception, aesthetic design and superior level of cleanliness for a perfect compatibility

Airtight, antistatic packaging

Full flow

100 % leak-tested, date coding to guarantee quality and traceability

ASTM G93-03 B 300, ISO 15001, VDI 2083

Conform to CGA G4.1 and DI93/42/EC

Details

ØD:	4 mm
C:	R1/8"
F1:	11
F2:	3
H:	18
Maximum working pressure in bar:	15
Material seal:	EPDM
Material body:	Biobased raw materials
Material toothed washer:	Stainless steel
min. temperature in °C:	-10
max. temperature in °C:	95
Vacuum resistance in mm Hg:	755
Material:	Biobased raw materials
RoHS compliant:	Yes
Weight in kg:	0,003

Dimensions

ØD:	4 mm
C:	R1/8"
F1:	11
F2:	3
H:	18