

## Datasheet of 6814 10 21 Stud fitting

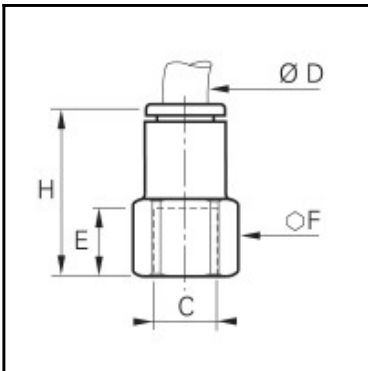

### Description

Stud fitting CleanFit®, Brass nickel plated chemical fda brass, 10 mm, G1/2"

In line connection of tubing with a male thread. Tightened on the top of the fitting with a flat spanner or socket wrench

Robust eco-conception, aesthetic design and superior level of cleanliness for a perfect compatibility

Airtight, antistatic packaging

Full flow

100 % leak-tested, date coding to guarantee quality and traceability

ASTM G93-03 B 300, ISO 15001, VDI 2083

Conform to CGA G4.1 and DI93/42/EC

### Details

ØD:	10 mm
C:	G1/2"
E:	19,5
F:	24
H:	41,5
Maximum working pressure in bar:	15
Material seal:	EPDM
Material body:	Brass nickel plated chemical fda brass
Material toothed washer:	Stainless steel
min. temperature in °C:	-10
max. temperature in °C:	95
Vacuum resistance in mm Hg:	755
Material:	Brass nickel plated chemical fda brass
RoHS compliant:	Yes
Weight in kg:	0,048

### Dimensions

ØD:	10 mm
C:	G1/2"
E:	19,5
F:	24
H:	41,5